

Additional Addendum Material Packet (9-21-20)

Town of Norwich

Agenda for Selectboard Meeting September 23, 2020, 6:30 pm

Remote Meeting

ZOOM access information: <https://us02web.zoom.us/j/88091849218> Meeting ID: 880 9184 9218 US Toll-free: (888)475-4499 or (877)853-5257

Telephone number to call ONLY if unable to access meeting: 802-649-1419 x1 (Town Manager's Office)

Agenda Item	Action	Packet Materials	Expected start & end time
1- Approval of the agenda	Chair: will ask to add/remove/reorder agenda items	n/a	6:30 - 6:35 (5 minutes)
2- Public and Selectboard comment	Public invited to speak to any item not on the agenda	n/a	6:35 - 6:45 (to completion)
3- Consent Agenda	Accept correspondence, minutes for 8/26,2020, A/P warrants-motion required	Correspondence received (list attached at the end of agenda), minutes, A/P warrants	6:45 - 6:55 (10 minutes)
4-Appropriation request by Rec Dpt	Approve request from Rec Dpt to use Girard Fund for purchase of chairs-motion required	Supporting documents	6:55-7:05 (10 minutes)
5-Mt. Ascutney grant request	Approve possible outstanding grant funds available to the Town from Mt. Ascutney grant-motion required	??	7:05-7:15 (10 minutes)
6- Norwich School District Memorandum of Understanding (MOU) with Norwich Finance Committee	Approve 1 (one) year MOU between Norwich School District and Town of Norwich Finance Committee (FC) with subsequent participation in Dresden Finance Committee-motion required	Draft MOU	7:15-7:30 (15 minutes)
7-Town of Norwich/Norwich School District MOU	Information only	MOU between Norwich School District and Town of Norwich	7:30-7:40 (10 minutes)
8-Planning Commission request to apply for a municipal planning grant	Authorize PC application for Municipal Planning Grant r/t density study and approve resolution	Supporting documentation	7:40-7:50 (10 minutes)
BREAK			7:50-8:00 (10 minutes)

Town of Norwich  
 Agenda for Selectboard Meeting September 23, 2020, 6:30 pm (Cont...)  
 Remote Meeting

<b>Agenda Item</b>	<b>Action</b>	<b>Packet Materials</b>	<b>Expected start &amp; end time</b>
9-Revenue/Expense report for August 2020	Discussion on current financial position	Aug 2020 R/E report (forthcoming in revised packet)	8:00-8:15 (15 minutes)
10-FY21/22 Operational and CIP Budget Guidance from Board	Discussion on FY22 budget and CIP with the goal of providing direction to TM on what, if any, tax increase is acceptable for FY22	n/a	8:15-8:35 (20 minutes)
11-Town Plan Action Items for 2020 Update	Update on Town Plan action items	There will be material here just not ready yet	8:35-8:45 (10 minutes)
12-Bank Loan for financing construction of Charles Brown Brook bridge	Approve loan agreement between Town of Norwich and Northfield Savings Bank financing bridge construction-motion required	Supporting documents (bank docs in packet; additional background info in revised packet)	8:45-9:00 (15 minutes)
13-Town Manager Update	Discussion	Reports in packet	9:00-9:20 (20 minutes)
14- Executive Session-personnel	Executive session for the board to review TM Improvement plan/evaluation tool	n/a	9:20-9:55 (25 minutes)
15- Adjourn	Motion required		Way too late

**List of correspondence received before Noon on Wednesday, September 16, 2020:**

- Norwich Selectboard – Resolution Supporting the Global Warming Solutions Act of 2020, as adopted 8/26/20.
- 8/24/20 e-mail from Roger Arnold to Selectboard re: TM Capacity for Solar Credit Tracking
- 8/27/20 e-mail from Pam Smith to Selectboard re: Used Generator
- 9/2/20 e-mail from Pam Smith to Selectboard, Herb Durfee, Miranda Bergmeier re: Beaver Meadow Sidewalk Study Project
- 9/3/20 memorandum from VT PUC to Margo Avery Trust re: Notice of Complete Application (20-2276-NM)
- Template for Town of Norwich Committee/Commission/Workgroups Meetings for Compliance with the OML during the Declared State of Emergency
- 8/31/20 e-mail from Pam Smith to Miranda Bergmeier re: Suggested Change to the SB Minutes for 8/26/20

Town of Norwich

Agenda for Selectboard Meeting September 23, 2020, 6:30 pm (Cont...)

Remote Meeting

- Draft Selectboard Minutes of 8/26/20
- A/P Warrants (2 = Regular & Girard Special Purpose Fund), dated 9/15/20

**Possible Oct/Nov Items** : COVID-19 update; Trails Committee discussion/website and Nick K memo; Town Plan work; policy revisions- conservation fund policy, Animal ordinance, SB correspondence, cyber security; FD ladder truck; Union contract; budget discussions/Capital Improvement Plan; net metering agreement; Village Designation application; Beaver Meadow scoping project results of public hearing; Schoolboard presentation to town on school septic project

**Parking Lot:** Financial Procedures; SB Goal setting; Emerald Ash borer town response; Green Fleet proposal, Town meeting article on Climate emergency funds write up on indications for use; Juneteenth resolution discussion and plan

ADDITIONAL  
3

**Herb Durfee**

---

**From:** Melissa Horwitz <horwitzmelissa@gmail.com>  
**Sent:** Friday, August 28, 2020 1:19 PM  
**To:** Herb Durfee  
**Subject:** Resignation from CRJC Upper Valley Subcommittee

PT RIVER JOINT COMMISSIONS

Dear Herb and Members of the Selectboard,

I am writing to inform you that I am resigning my position as the Norwich Representative on the CRJC Upper Valley Subcommittee. Unfortunately, I have too many commitments at this time to continue. I have enjoyed my time on this committee and I think it is important for Norwich to continue to have representation.

I would be happy to answer any questions for future applicants.

Thank you for this opportunity.

Best,

Melissa Horwitz  
6 Spur Lane

2 VACANCIES



# Local River Subcommittees

## Nomination Form for Municipal Representative

MUNICIPALITY: \_\_\_\_\_

DATE: \_\_\_\_\_

NOMINEE NAME: \_\_\_\_\_

INTEREST(S) NOMINEE IS REPRESENTING: *(check all that applies)*

Local Government

Recreation

Business

Agriculture

Conservation

Riparian Landowners

### NOMINEE MAILING ADDRESS:

Street Address \_\_\_\_\_

City \_\_\_\_\_ State \_\_\_\_\_ Zip \_\_\_\_\_

NOMINEE PHONE NUMBER: \_\_\_\_\_

NOMINEE EMAIL: \_\_\_\_\_

### Chair of Selectboard or Authorized Signature(s)

Name: \_\_\_\_\_

Title: \_\_\_\_\_

*Please return to:*

*Connecticut River Joint Commissions*

*10 Water Street, Suite 225, Lebanon, NH 03766*

*Or by e-mail: [pcrocker@uvlsrpc.org](mailto:pcrocker@uvlsrpc.org)*

*Or by fax: (603) 448-0170*

*Questions? – Please call CRJC at (603) 727-9484*



## *Local River Subcommittees* YOUR VOICE ON THE CONNECTICUT RIVER

# Becoming Familiar with CRJC Local River Subcommittees

This welcome packet is meant to orient you to the work of the five Local River Subcommittees that are a part of the Connecticut River Joint Commissions, collectively protecting the Connecticut River Valley's natural resources.

### **Content**

Who is the Connecticut River Joint Commissions or "CRJC"?

Who are the Local River Subcommittees or "LRS"?

What does Local River Subcommittee membership involve?

Appendix

*For more information*

Contact Local River Subcommittee Staff

Olivia Uyizeye – Office (603) 448-1680 or Email [ouyizeye@uvlsrpc.org](mailto:ouyizeye@uvlsrpc.org)

---

## Who is the Connecticut River Joint Commissions or "CRJC"?

### Organizational History

Connecticut River Commissions were created by NH and VT in 1987/1988 and directed to cooperate with each other to preserve and protect the visual, ecological and agricultural resources of the Connecticut River Valley, as well as guide its growth and development. They have met together as the Joint Commissions since 1989. Both Commissions are advisory for decisions which affect their river and valley.

See the enabling legislation on the [CRJC website](#) or attached (Appendix Page 115).

### Mission & Geography

The CRJC inform policy decisions, links local action to state and federal initiatives, and convenes partners in a common effort to protect the Valley's resources. See the CRJC Strategic Plan 2020 (Appendix Page 2).

The CRJC work falls within the Connecticut River Watershed and/or Valley situated in the states of NH and VT. It is an accepted "Designated River" in NH meaning it is managed and protected for its outstanding natural and cultural resources in accordance with The NH Rivers Management & Protection Act.

## Organizational Structure and Bylaws

The business of the CRJC are managed under the direction of an Association of Commissioners comprised of all those appointed from both states to serve as members of their respective Commission. Find out more about the CRJC bylaws on the [CRJC website](#) or attached (Appendix Page 125).

---

## Who are the Local River Subcommittees or "LRS"?

### History

The CRJC work to bring decision-making back home to the people of the Connecticut River Valley. To ensure local leadership of river issues, the CRJC established five Local River Subcommittees (LRS) in January 1993, with the specific approval of the NH legislature. The VT legislature also directed its 27 riverfront communities to participate. They are advisory and have a statutory role in NH (see details [here](#) or Appendix Page 143). Each LRS makes up a portion of participating riverfront communities.

### Membership

The CRJC asks the Selectboard of all 53 of the riverfront towns for nominations and appoints up to two members and several alternates from each town. The strength of the LRS lies in the diversity of their membership. NH law requires that they represent local business, local government, agriculture, riverfront landowners, recreation, and conservation interests. There is never a dull moment around the table!

As a whole, our LRS are composed of over a hundred appointed citizens representing their riverfront towns, voicing their perspective. Their leadership, planning, and expertise are local in nature, and their ideas range far beyond town boundaries as they advise the array of federal, state and municipal agencies, as well as CRJC, on river issues.

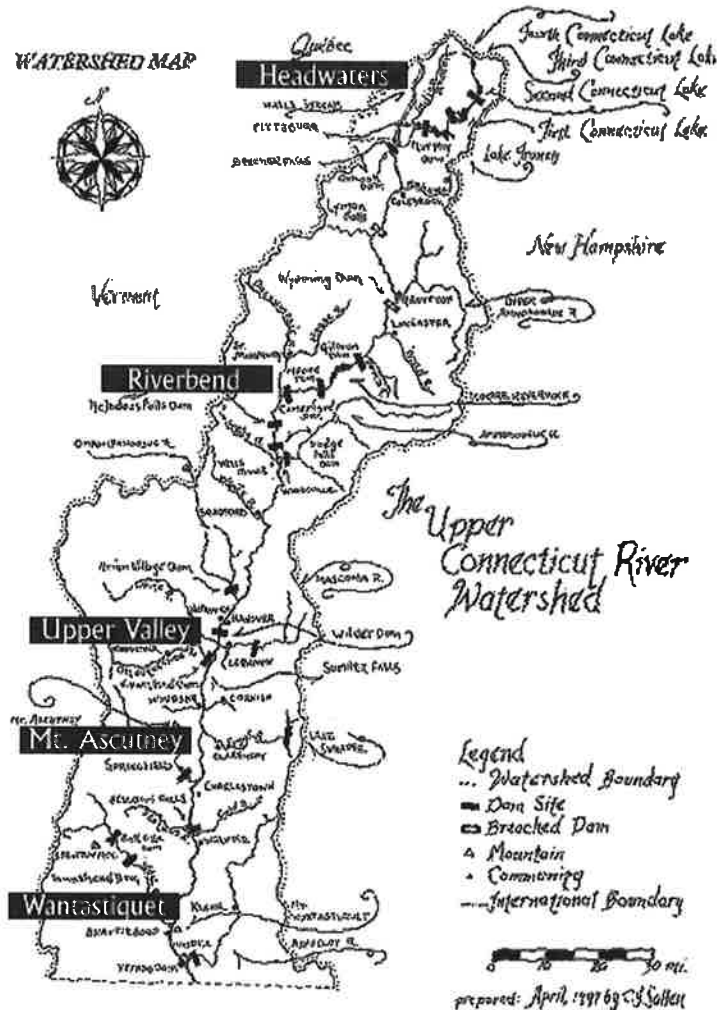

## Voting

For Local River Subcommittees, a quorum shall be defined as: any number of members present, provided that half of participating municipalities are represented. Participating municipalities are those with duly-appointed members. Determinations of any matter shall require the concurrence of a majority of members present at that meeting. If it is apparent that VT members are voting differently from NH members, the Chair may direct that separate votes be taken and the results will become part of the record. LRS shall observe Vermont and New Hampshire open meeting laws.

## Member Officers

Annually, each LRS shall elect a Chair and a Vice-Chair from the voting members, and other officers as it deemed necessary. These officers shall hold their respective offices for one year or until their successors are elected and qualified by a majority vote on a formal motion. The Chair shall call the meeting together and preside over all meetings of the LRS. The Vice-Chair shall assume the duties and powers of the Chair in the Chair's absence. Any vacancy among the LRS officers shall be filled by election, for the unexpired term, at the next regular meeting.

---

## What does Local River Subcommittee membership involve?

### Member Responsibilities

To be most effective, each LRS needs representation from each town and many perspectives. Your voice is an important component. Meetings are no more than two hours in the evening and take place 4 to 6 times per year. In addition, members spend time on the following:

- ❖ Contact person for your town officials about river-related issues.
- ❖ Help your town put the Connecticut River Management Plan into action.
- ❖ Provide advice about permit applications for projects that could affect the river, including site visits that occur outside of normal meeting times.
- ❖ Advise the CRJC on issues of concern to you or your town, such as water quality problems or main street revitalization.
- ❖ Shape the work being done for our valley by federal and state agencies (guide the Conte Refuge, US Fish & Wildlife Service, EPA, NRCS, National Park Service, and others on how they can best do their job in the region).
- ❖ Contribute to the meeting agenda on specific matters of discussion, concern or acknowledgment.

If you are no longer able to serve, please notify your town and CRJC office with a letter of resignation.

### Techniques of an effective member

#### *Keep Informed, Participate, Build Support and Strengthen Relationships*

Your attendance and participation in meetings is central to our LRS functioning. Take some time to read through the meeting agenda and materials ahead of time. Ask questions – all are relevant and necessary. Create space for other members voice their questions and reflections. Where you can, help other members see the whole issue and all sides of complex items. If you cannot attend, call or email the CRJS office so staff knows. Arrange to get your opinions to the meetings and follow up to learn what you missed.



As a member representing your home community, it is important to keep up to date with your community's activity including, but not limited to, Selectboard, Planning Board, Zoning Board of Adjustment, and Conservation Commission. You may also want to share brief reports with your community about LRS activities, whether it be by chatting at the post office or presenting to the Selectboard. Find a method that works for you. Work with your town to identify local and regional needs or concerns to be taken back to your LRS.

If you are willing and able, become acquainted with the state officials who deal with your region and build a friendly relationship with them. Assess the LRS priorities and link them, whenever possible, to the priorities of these officials. Let them know LRS contributions on a topic and where you stand on legislative issues. When your representatives take a position you support, let them know you support them and ask how you can help.

## Major Subcommittee Responsibilities

### *NEW HAMPSHIRE DEPARTMENT OF ENVIRONMENTAL SERVICES PERMITTING PROCESS*

The LRS are established by law as Local River Management Advisory Committees, abbreviated to LACs. The LACs are given the authority to review New Hampshire Department of Environmental Services (NHDES) shoreland, wetland and alteration of terrain permit applications for projects within ¼ mile of the Connecticut River. The LAC's conduct investigations, usually with a visit to the site, and report to NHDES with recommendations. Our local knowledge and input is a vital part of the permitting process, and NHDES must incorporate our recommendations in their decisions. For more information visit the NH Rivers Management and Protection Program on [the NHDES website](#).

### *VERMONT TACTICAL BASIN PLANS*

Vermont Department of Environment Conservation (DEC) identifies 12 areas where tactical basin plans are organized around, seven of which include land within the Connecticut River watershed. Basin planners undergo a 5-year planning process including assessment of water quality and habitat, compilation of monitoring data, community feedback and improvement strategies. The LRS are consulted as a local stakeholder and partner to the plan. The outcome includes a list of projects that would benefit the basin. For more information [visit the DEC website](#).

## Learn more about your Local River Subcommittee

The CRJC hosts a library of past meeting minutes and watershed management publications on our website [www.crjc.org](http://www.crjc.org). Before your first meeting, you are encouraged to review minutes from the prior two meetings of your LRS.

Publications include river wide and LRS plans in regards to Corridor Management, Recreation Management and Water Resources Management. Other publications have been produced on topics including riparian buffers, boating and historic sites. These are useful resources to review prior and over the course of your membership. See the Riverwide Water Resources Management Plan (Appendix Page 11).

Our staff welcomes you to contact the CRJC office with specific questions any time.

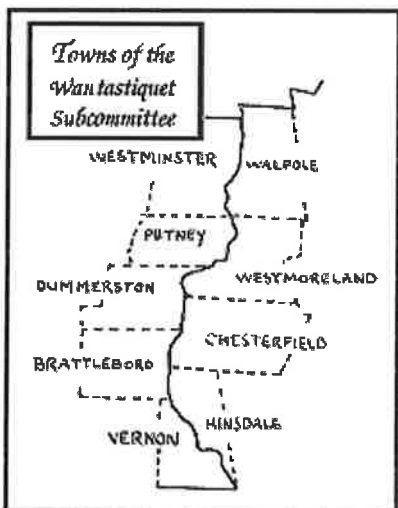
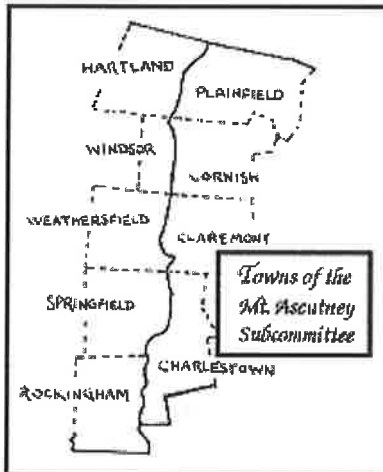
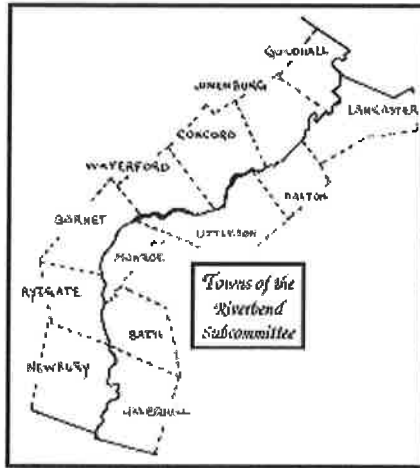

NORWICH PLANNING COMMISSION  
Thursday, July 23, 2020 6:30pm

DRAFT MINUTES

---

Zoom Meeting: <https://us02web.zoom.us/j/86340389705>

Meeting ID: 863 4038 9705

Members Present: Melissa Horwitz (C), Brian Loeb, Jaci Allen, Jeff Goodrich, Ernie Ciccotelli, Jeff Lubell, Leah Romano  
Public Present: Linda Cook  
Staff: Rod Francis

**Meeting Opened:** 6:34pm

1. Approve Agenda  
Allen moved and Goodrich seconded a motion to approve the Agenda. Motion carried: 7  
— 0
2. Meeting Objectives:
  - o Report on Town Plan action items
  - o Discuss Affordable Housing Subcommittee Recruitment
  - o Report from Wastewater working group
  - o Debrief on town plan process
3. Comments from the Public. None
4. Review and approve Minutes June 24, 2020  
Allen moved and Romano seconded a motion to approve the minutes of 4-23-20. Motion carried 6 - 0 - 1.
5. Announcements, Reports, Updates & Correspondence
  - o Correspondence: Tucker Hill Rd Solar Project. Francis summarized the policy from 2020 Town Plan which presumes 'preferred status', *except where* the site is located in an overlay zoning district ensuring natural and cultural resource protection (see Plan policy 3-2.h page 22). This site is in the Ridgeline Protection Overlay district.
  - o Updates
    - i. TRORC: Francis reported that the regional plan was approved. The 6-town Regional Energy Coordinator appointment was announced
  - o Reports (None)
6. Report on Town Plan action items Allen updated the meeting on feedback received from officers, commissions and committees that received a copy of action items which they are responsible for under the 2020 town plan.
7. Discuss Affordable Housing Subcommittee Recruitment (Jeff Lubell)  
Application from Gordon Greenfield

After discussing the application from Gordon Greenfield Lubell moved and Goodrich seconded a motion to appoint Greenfield to the Affordable Housing Subcommittee (AHSC). Motion carried 7 – 0.

A mission statement and draft bylaws will be available for discussion at the next meeting.

8. Report from wastewater working group (WWWG). Romano reported that the working group had no additional comments on the draft scoping statement and felt that it served the intended purpose of framing the issue for any subsequent grant applications for funding a study.

The working group will develop a “menu of topics” for further review.

The working group asked that this topic stay on future agendas

Goodrich expressed that he was not in favor of this draft scoping statement and asked how he could engage directly with this working group on this issue.

Commissioners discussed next steps for the working group.

Commissioners sought an update on the situation with Marion Cross School (MCS) septic system. Horwitz informed Commissioners that Tom Candon of the MCS Board has indicated an interest in discussing the topic of wastewater

9. Debrief on town plan process (Leah Romano) Deferred.

10. Other Business. (None)

11. Future Meeting Schedule & Agendas

- Wastewater Working Group: study scope (August)
- 2020 Town Plan: Debrief (September)
- AHSC guidance for working groups under Open Meeting Law (OML) (September)

12. Comments from the Public (None)

Meeting Adjourned 7:55pm

**Future Meetings:**

**Thursday August 27, 6:30pm Regular Meeting**

**Thursday September 24, 6:30pm Regular Meeting**

**Subject:** Margo Avery Trust 297 Tucker Hill Rd, Norwich  
**From:** Rod Francis <norwichvtplanner@gmail.com>  
**Date:** 7/28/2020, 2:53 PM  
**To:** omearasolar@gmail.com

Darren,

I acknowledge receipt of your packet in the mail providing 45 day notice pursuant to 30 VSA Section 8010 and 248 and Public Utility Commission Rule 5.107 (B).

The Norwich Town Plan adopted March 7, 2020 contains the following policy on page 22:

**3-2.h** For solar generation projects sized from 15kW to 500kW the presumption is that all of Norwich meets the Public Utility Commission definition of 'preferred site', notwithstanding the existing areas of local concern including the Ridgeline Protection Overlay Area, Shoreline Protection Overlay Area and the historic village district as identified in the Norwich Land Use Regulations. (emphasis added)

As you can see from the accompanying map, the project is proposed for a parcel that lies in the Ridgeline Protection Overlay Area. The project is not located in an area of town where 'preferred site' status can be conferred.

The level of documentation provided prevents me from concluding that the development is not visible from a public road, or other standards as set out in the Norwich Zoning Regulations (NZR), as amended 2009 p29) These regulations may be downloaded here:

<http://norwich.vt.us/wp-content/uploads/2012/06/Norwich-Zoning-Regulations-Amended-07-01-09.pdf>

Sincerely,

Rod Francis  
Planning Director  
Zoning Administrator  
Town of Norwich

— Attachments: —

Prop. Net Metered Solar Array Tucker Hill Rd.pdf

231 KB

ADDITIONAL  
3

**Pam Mullen**

---

**From:** Rod Francis <norwichvtplanner@gmail.com>  
**Sent:** Saturday, September 19, 2020 7:55 AM  
**To:** claudette brochu  
**Cc:** Herb Durfee; John Langhus; Mary Layton; rgere@mac.com; Roger Arnold; Miranda Bergmeier; Pam Mullen; Melissa Horwitz  
**Subject:** Re: FW: 9-23-20 Selectboard Agenda and Packet

The 2020 town plan policy makes the response to a request for 'preferred site' status an administrative decision. This decision has been made by me and is now recognized by the PUC.

As a courtesy the applicants were provided information to ensure that they understood the decision and how they could provide information that would allow a different decision to be made by me.

The applicants have not responded to this information.

The applicants have not met the requirements of the PUC application process (failure to provide us as an interested party with a complete application and notice).

The town has the right to intervene in the proceedings now. But to be consistent with written policy it would be confined to restating my decision and perhaps pointing out the applicant has failed to meet their obligations.

I hope this makes it clearer.

Rod

On Fri, Sep 18, 2020, 21:03 claudette brochu <[cbrochu30@gmail.com](mailto:cbrochu30@gmail.com)> wrote:

Hi Herb,

I was on the PUC last night reviewing what had been submitted. I read the application and Rod's email exchanges with the solar company. What I could not find on the town website were the PC minutes and if/how the PC was going to respond. Thanks Rod for the info.

C

Please note that any reply or response to this email is subject to the disclosure provisions under the Vermont Open Meeting Law and Public Records Act..

On Fri, Sep 18, 2020 at 9:57 AM Herb Durfee <[HDurfee@norwich.vt.us](mailto:HDurfee@norwich.vt.us)> wrote:

Claudette,

Following is the PUC link to the Margo Avery Trust (applicant) "case details".

<https://epuc.vermont.gov/?q=node/64/151449/FV-Case%20Summary-Portal>

Attached, from that link, are the summary details from each of the portal's "tabs" (i.e., Summary, People, Schedule, Commission-Issued Documents, Prefiled Testimony/Exhibits/Affidavits, All Other Documents, Public Comment, and Case Log). While I didn't include all the gory details, I did print the Norwich Zoning Administrator's e-mail string with Darren O'Meara and the site plan on file. If you wish to dive further into the application's details, once you're in the portal, wherever you see a "magnifying glass inside a box" that means there is a document. To view that document, click on the magnifying glass.

Note the attachment has some blank pages. That's because I scanned the information back-to-back; some pages were single-sided and others were double-sided. So, nothing is missing in the scan.

Also, I checked the 2020 minutes of the PC posted on the Town webpage. Unless I missed something, I don't believe the PC discussed this application. But, I'll let Rod/Melissa correct me, if I'm in error.

This e-mail and its attachment will be included in next week's revised/amended packet.

*Herb*

Herbert A. Durfee, III

Town Manager

Town of Norwich

PO Box 376

Norwich, VT 05055

802-649-1419 ext. 102

802-698-3000 (cell)

802-649-0123 (fax)

**From:** claudette brochu [mailto:[cbrochu30@gmail.com](mailto:cbrochu30@gmail.com)]

**Sent:** Thursday, September 17, 2020 9:48 PM

**To:** Herb Durfee

**Cc:** Roger Arnold; claudette brochu

**Subject:** Re: FW: 9-23-20 Selectboard Agenda and Packet

Hi Herb,

With my very quick first pass at reviewing the packet material, I noted the Tucker Hill solar array proposal. I had seen mention of this in PC minutes and remembered that this project is sited in the Ridgeline protected area of the Town Plan. I have sent an email to Melissa to get a copy of the PC minutes or some clarity on if any decision was made by the PC to either support this project or to provide testimony to the PUC in opposition. If this material can be part of the packet revision, I think it would be helpful.

This project is clearly part of the message in John's memo but also will be a test of the Town Plan. What is the purpose of a TP if the protections in place to preserve the ridgelines and forests are not enforced?

C

Please note that any reply or response to this email is subject to the disclosure provisions under the Vermont Open Meeting Law and Public Records Act..

On Thu, Sep 17, 2020 at 3:45 PM Herb Durfee <[HDurfee@norwich.vt.us](mailto:HDurfee@norwich.vt.us)> wrote:

Board Members,

Below is the link to you agenda/packet. There will be a revised/amended packet next week.

Herb

Herbert A. Durfee, III

Town Manager

Town of Norwich

PO Box 376

Norwich, VT 05055



802-649-1419 ext. 102

802-698-3000 (cell)

802-649-0123 (fax)

---

**From:** Pam Mullen  
**Sent:** Thursday, September 17, 2020 2:52 PM  
**To:** Pam Mullen  
**Subject:** FW: 9-23-20 Selectboard Agenda and Packet

Selectboard Agenda and Packet for Wednesday, September 23, 2020 is up on the Town Website at:

Agenda: [http://norwich.vt.us/wp-content/uploads/2020/09/Selectboard-Agenda-09\\_23\\_2020.pdf](http://norwich.vt.us/wp-content/uploads/2020/09/Selectboard-Agenda-09_23_2020.pdf)

Packet: <http://norwich.vt.us/wp-content/uploads/2020/09/Selectboard-Packet-09-23-2020.pdf>

Please note that it is anticipated that the Packet will be revised next week.



Pam Mullen for Miranda Bergmeier  
Assistant to the Town Manager  
Town of Norwich  
P.O. Box 376  
Norwich, VT 05055  
802-649-1419 x101

Please note that any response or reply to this electronic message may be subject to disclosure as a public record under the Vermont Public Records Act.

# Prop. Net metered array Tucker Hill Rd

Write a description for your map.

## Legend

-  0
-  approx array
-  Hartford

 approx array

Google Earth

© 2020 Google



1000 ft

**Subject:** Fwd: Solar site consideration to be considered under 'correspondence'  
**From:** Rod Francis <norwichvtplanner@gmail.com>  
**Date:** 7/23/2020, 2:00 PM  
**To:** Herb Durfee <hdurfee@norwich.vt.us>, Miranda Bergmeier <mbergmeier@norwich.vt.us>

Rod Francis  
Planning Director  
Zoning Administrator  
Town of Norwich

----- Forwarded message -----

**From:** Rod Francis <norwichvtplanner@gmail.com>  
**Date:** Thu, Jul 23, 2020 at 1:55 PM  
**Subject:** Solar site consideration to be considered under 'correspondence'  
**To:** [ernieciccotelli@gmail.com](mailto:ernieciccotelli@gmail.com) <[ernieciccotelli@gmail.com](mailto:ernieciccotelli@gmail.com)>, Jaci Allen <[allenjaci@gmail.com](mailto:allenjaci@gmail.com)>, Jeff Lubbell abt <[Jeffrey\\_Lubell@abtassoc.com](mailto:Jeffrey_Lubell@abtassoc.com)>, [jeff.goodrich@pathwaysconsult.com](mailto:jeff.goodrich@pathwaysconsult.com) <[jeff.goodrich@pathwaysconsult.com](mailto:jeff.goodrich@pathwaysconsult.com)>, [jefflubell@yahoo.com](mailto:jefflubell@yahoo.com) <[jefflubell@yahoo.com](mailto:jefflubell@yahoo.com)>, leah romano <[leah.romano@gmail.com](mailto:leah.romano@gmail.com)>, [loebbrian@gmail.com](mailto:loebbrian@gmail.com) <[loebbrian@gmail.com](mailto:loebbrian@gmail.com)>, Melissa Horwitz <[melissahorwitz@yahoo.com](mailto:melissahorwitz@yahoo.com)>, rod francis <norwichvtplanner@gmail.com>, Herb Durfee <[hdurfee@norwich.vt.us](mailto:hdurfee@norwich.vt.us)>, Miranda Bergmeier <[mbergmeier@norwich.vt.us](mailto:mbergmeier@norwich.vt.us)>

Commissioners,

Attached are materials for consideration under Item 5: Correspondence. I apologize for the oversight.

Item Description:

1. Correspondence: Prop. Net Metered Solar Array Tucker Hill RD.pdf

This is the submission from petitioner(s) (the applicants) to the Public Utility Commission (PUC) for a 29.4 kW net metered solar project.

Under Vermont statute and PUC rules the town must be informed of the petitioners proposed project. The town is further being asked (pursuant to PUC rules) to 'support' this application.

2. Prop Net Metered Solar Array Tucker Hill Rd.pdf

This is a map I prepared to assist you in your deliberations on the matter. The map depicts an approximate location of the proposed project on a parcel subject to the Ridgeline Buffer Overlay District.

Resources for PC Response:

The relevant section of the 2020 Town Plan is Policy 3.2h (page 22), excerpted below:

3-2.h For solar generation projects sized from 15kW to 500kW the presumption is that all of Norwich meets the Public Utility Commission definition of 'preferred site', notwithstanding the existing areas of local concern including the Ridgeline Protection Overlay Area, Shoreline Protection Overlay Area and the historic village district as identified in the Norwich Land Use Regulations.

This policy is discussed on p28 of the plan.

I will be available to answer any questions you may have at tonight's meeting.

Rod Francis  
Planning Director  
Zoning Administrator  
Town of Norwich

-- Attachments:

---

Prop. Net Metered Solar Array Tucker Hill Rd.lr.pdf

231 KB

SolarProject\_TuckerHill\_AveryTrust\_6-25-20.lr.pdf

394 KB

**Subject:** Margo Avery Trust 297 Tucker Hill Rd, Norwich  
**From:** Rod Francis <norwichvtplanner@gmail.com>  
**Date:** 7/28/2020, 2:53 PM  
**To:** omearasolar@gmail.com

Darren,

I acknowledge receipt of your packet in the mail providing 45 day notice pursuant to 30 VSA Section 8010 and 248 and Public Utility Commission Rule 5.107 (B).

The Norwich Town Plan adopted March 7, 2020 contains the following policy on page 22:

3-2.h For solar generation projects sized from 15kW to 500kW the presumption is that all of Norwich meets the Public Utility Commission definition of 'preferred site', notwithstanding the existing areas of local concern including the Ridgeline Protection Overlay Area, Shoreline Protection Overlay Area and the historic village district as identified in the Norwich Land Use Regulations. (emphasis added)

As you can see from the accompanying map, the project is proposed for a parcel that lies in the Ridgeline Protection Overlay Area. The project is not located in an area of town where 'preferred site' status can be conferred.

The level of documentation provided prevents me from concluding that the development is not visible from a public road, or other standards as set out in the Norwich Zoning Regulations (NZR), as amended 2009 p29) These regulations may be downloaded here:

<http://norwich.vt.us/wp-content/uploads/2012/06/Norwich-Zoning-Regulations-Amended-07-01-09.pdf>

Sincerely,

Rod Francis  
Planning Director  
Zoning Administrator  
Town of Norwich

— Attachments: —

Prop. Net Metered Solar Array Tucker Hill Rd.pdf

231 KB

**Subject:** Re: Margo Avery Trust 297 Tucker Hill Rd, Norwich  
**From:** "Darren O'Meara" <omearasolar@gmail.com>  
**Date:** 7/28/2020, 9:03 PM  
**To:** Rod Francis <norwichvtplanner@gmail.com>

Hi Rod,

Thank you for sending this along. Could you meet me at the proposed site to determine whether the location of the array meets the intent of the Town's preferred site criteria? It is very well hidden, and sits below the ridgeline.

Thanks,  
Darren

On Tue, Jul 28, 2020 at 2:52 PM Rod Francis <[norwichvtplanner@gmail.com](mailto:norwichvtplanner@gmail.com)> wrote:

Darren,

I acknowledge receipt of your packet in the mail providing 45 day notice pursuant to 30 VSA Section 8010 and 248 and Public Utility Commission Rule 5.107 (B).

The Norwich Town Plan adopted March 7, 2020 contains the following policy on page 22:

3-2.h For solar generation projects sized from 15kW to 500kW the presumption is that all of Norwich meets the Public Utility Commission definition of 'preferred site', notwithstanding the existing areas of local concern including the Ridgeline Protection Overlay Area, Shoreline Protection Overlay Area and the historic village district as identified in the Norwich Land Use Regulations. (emphasis added)

As you can see from the accompanying map, the project is proposed for a parcel that lies in the Ridgeline Protection Overlay Area. The project is not located in an area of town where 'preferred site' status can be conferred.

The level of documentation provided prevents me from concluding that the development is not visible from a public road, or other standards as set out in the Norwich Zoning Regulations (NZR), as amended 2009 p29) These regulations may be downloaded here:

[http://norwich.vt.us/wp-content/uploads/2012/06/Norwich-Zoning-Regulations Amended 07-01-09.pdf](http://norwich.vt.us/wp-content/uploads/2012/06/Norwich-Zoning-Regulations-Amended-07-01-09.pdf)

Sincerely,

Rod Francis  
Planning Director  
Zoning Administrator  
Town of Norwich

--

O'Meara Solar  
[www.omearasolar.com](http://www.omearasolar.com)  
802-522-2381

**Subject:** Re: Margo Avery Trust 297 Tucker Hill Rd, Norwich  
**From:** Rod Francis <norwichvtplanner@gmail.com>  
**Date:** 7/28/2020, 9:32 PM  
**To:** "Darren O'Meara" <omearasolar@gmail.com>

Darren,

I am afraid that is not possible.

Even before covid-19 this would not be a solution. It is not a matter of my observation in the field.

You will need a technical visual impact analysis that demonstrates that any visual impact meets the standards set forth in the pertinent section of the Zoning Regulations I referenced. You can talk with your landscape architect about the specific methods used to conduct this work. There are companies that specialize in this work also.

It is up to you and the property owners to decide whether the project is viable without 'preferred site' status being conferred by the Town, and/or the expense of establishing that there is no meaningful visual impact.

Rod Francis  
Planning Director  
Zoning Administrator  
Town of Norwich

On Tue, Jul 28, 2020 at 9:03 PM Darren O'Meara <omearasolar@gmail.com> wrote:

Hi Rod,

Thank you for sending this along. Could you meet me at the proposed site to determine whether the location of the array meets the intent of the Town's preferred site criteria? It is very well hidden, and sits below the ridgeline.

Thanks,  
Darren

On Tue, Jul 28, 2020 at 2:52 PM Rod Francis <norwichvtplanner@gmail.com> wrote:

Darren,

I acknowledge receipt of your packet in the mail providing 45 day notice pursuant to 30 VSA Section 8010 and 248 and Public Utility Commission Rule 5.107 (B).

The Norwich Town Plan adopted March 7, 2020 contains the following policy on page 22:

3-2.h For solar generation projects sized from 15kW to 500kW the presumption is that all of Norwich meets the Public Utility Commission definition of 'preferred site', notwithstanding the existing areas of local concern including the Ridgeline Protection Overlay Area, Shoreline Protection Overlay Area and the historic village district as identified in the Norwich Land Use Regulations. (emphasis added)

As you can see from the accompanying map, the project is proposed for a parcel that lies in the Ridgeline Protection Overlay Area. The project is not located in an area of town where 'preferred site' status can be conferred.

The level of documentation provided prevents me from concluding that the development is not visible from a public road, or other standards as set out in the Norwich Zoning Regulations (NZR), as amended 2009 p29) These regulations may be downloaded here:

[http://norwich.vt.us/wp-content/uploads/2012/06/Norwich-Zoning-Regulations Amended 07-01-09.pdf](http://norwich.vt.us/wp-content/uploads/2012/06/Norwich-Zoning-Regulations-Amended-07-01-09.pdf)

Sincerely,

Rod Francis  
Planning Director  
Zoning Administrator  
Town of Norwich

--

O'Meara Solar  
[www.omearasolar.com](http://www.omearasolar.com)  
802-522-2381



**Subject:** Re: Margo Avery Trust 297 Tucker Hill Rd, Norwich  
**From:** "Darren O'Meara" <omearasolar@gmail.com>  
**Date:** 7/28/2020, 9:44 PM  
**To:** Rod Francis <norwichvtplanner@gmail.com>

Hi Rod,

I understand. Do you happen to have a similar visual impact analysis that has been submitted to the town in the past, that I could look at?

Thanks,  
Darren

On Tue, Jul 28, 2020 at 9:31 PM Rod Francis <[norwichvtplanner@gmail.com](mailto:norwichvtplanner@gmail.com)> wrote:

Darren,

I am afraid that is not possible.

Even before covid-19 this would not be a solution. It is not a matter of my observation in the field.

You will need a technical visual impact analysis that demonstrates that any visual impact meets the standards set forth in the pertinent section of the Zoning Regulations I referenced. You can talk with your landscape architect about the specific methods used to conduct this work. There are companies that specialize in this work also.

It is up to you and the property owners to decide whether the project is viable without 'preferred site' status being conferred by the Town, and/or the expense of establishing that there is no meaningful visual impact.

Rod Francis  
Planning Director  
Zoning Administrator  
Town of Norwich

On Tue, Jul 28, 2020 at 9:03 PM Darren O'Meara <[omearasolar@gmail.com](mailto:omearasolar@gmail.com)> wrote:

Hi Rod,

Thank you for sending this along. Could you meet me at the proposed site to determine whether the location of the array meets the intent of the Town's preferred site criteria? It is very well hidden, and sits below the ridgeline.

Thanks,  
Darren

On Tue, Jul 28, 2020 at 2:52 PM Rod Francis <[norwichvtplanner@gmail.com](mailto:norwichvtplanner@gmail.com)> wrote:

Darren,

I acknowledge receipt of your packet in the mail providing 45 day notice pursuant to 30 VSA Section 8010 and 248 and Public Utility Commission Rule 5.107 (B).

The Norwich Town Plan adopted March 7, 2020 contains the following policy on page 22:

3-2.h For solar generation projects sized from 15kW to 500kW the presumption is that all of Norwich meets the Public Utility Commission definition of 'preferred site', notwithstanding the existing areas of local concern including the Ridgeline Protection Overlay Area, Shoreline Protection Overlay Area and the historic village district as identified in the Norwich Land Use Regulations. (emphasis added)

As you can see from the accompanying map, the project is proposed for a parcel that lies in the Ridgeline Protection Overlay Area. The project is not located in an area of town where 'preferred site' status can be conferred.

The level of documentation provided prevents me from concluding that the development is not visible from a public road, or other standards as set out in the Norwich Zoning Regulations (NZR), as amended 2009 p29) These regulations may be downloaded here:

[http://norwich.vt.us/wp-content/uploads/2012/06/Norwich-Zoning-Regulations Amended 07-01-09.pdf](http://norwich.vt.us/wp-content/uploads/2012/06/Norwich-Zoning-Regulations-Amended-07-01-09.pdf)

Sincerely,

Rod Francis  
Planning Director  
Zoning Administrator  
Town of Norwich

--  
O'Meara Solar  
[www.omearasolar.com](http://www.omearasolar.com)  
802-522-2381

--  
O'Meara Solar  
[www.omearasolar.com](http://www.omearasolar.com)  
802-522-2381

**Subject:** Re: Margo Avery Trust 297 Tucker Hill Rd, Norwich  
**From:** Rod Francis <[norwichvtplanner@gmail.com](mailto:norwichvtplanner@gmail.com)>  
**Date:** 7/29/2020, 8:09 AM  
**To:** "Darren O'Meara" <[omearasolar@gmail.com](mailto:omearasolar@gmail.com)>

Darren,

The Town has not needed a visual impact analysis for such a project since this Town Plan came into effect in March 2020.

The recent application from Norwich Technologies on Turnpike Road did include a visual impact analysis. This information may be available through the PUC (which means it would be in the public domain now). We don't hold the information because this part of the application was done to resolve issues with an abutter, the Town was not a party to the process, and therefore the work is not ours to share.

However, there are a few critical points to be made:

- The Turnpike Road site met the towns 'preferred site' status criteria
- The visual impact analysis and conclusions reached in regard to 'character of the area' used the so-called 'Quechee Test' which is NOT the threshold for analyzing visual impact in the Norwich Ridgeline Protection Overlay District

Rod Francis  
Planning Director  
Zoning Administrator  
Town of Norwich

On Tue, Jul 28, 2020 at 9:44 PM Darren O'Meara <[omearasolar@gmail.com](mailto:omearasolar@gmail.com)> wrote:

Hi Rod,

I understand. Do you happen to have a similar visual impact analysis that has been submitted to the town in the past, that I could look at?

Thanks,  
Darren

On Tue, Jul 28, 2020 at 9:31 PM Rod Francis <[norwichvtplanner@gmail.com](mailto:norwichvtplanner@gmail.com)> wrote:

Darren,

I am afraid that is not possible.

Even before covid-19 this would not be a solution. It is not a matter of my observation in the field.

You will need a technical visual impact analysis that demonstrates that any visual impact meets the standards set forth in the pertinent section of the Zoning Regulations I referenced. You can talk with your landscape architect about the specific methods used

to conduct this work. There are companies that specialize in this work also.

It is up to you and the property owners to decide whether the project is viable without 'preferred site' status being conferred by the Town, and/or the expense of establishing that there is no meaningful visual impact.

Rod Francis  
Planning Director  
Zoning Administrator  
Town of Norwich

On Tue, Jul 28, 2020 at 9:03 PM Darren O'Meara <[omearasolar@gmail.com](mailto:omearasolar@gmail.com)> wrote:

Hi Rod,

Thank you for sending this along. Could you meet me at the proposed site to determine whether the location of the array meets the intent of the Town's preferred site criteria? It is very well hidden, and sits below the ridgeline.

Thanks,  
Darren

On Tue, Jul 28, 2020 at 2:52 PM Rod Francis <[norwichvtplanner@gmail.com](mailto:norwichvtplanner@gmail.com)> wrote:

Darren,

I acknowledge receipt of your packet in the mail providing 45 day notice pursuant to 30 VSA Section 8010 and 248 and Public Utility Commission Rule 5.107 (B).

The Norwich Town Plan adopted March 7, 2020 contains the following policy on page 22:

3-2.h For solar generation projects sized from 15kW to 500kW the presumption is that all of Norwich meets the Public Utility Commission definition of 'preferred site', notwithstanding the existing areas of local concern including the Ridgeline Protection Overlay Area, Shoreline Protection Overlay Area and the historic village district as identified in the Norwich Land Use Regulations. (emphasis added)

As you can see from the accompanying map, the project is proposed for a parcel that lies in the Ridgeline Protection Overlay Area. The project is not located in an area of town where 'preferred site' status can be conferred.

The level of documentation provided prevents me from concluding that the development is not visible from a public road, or other standards as set out in the Norwich Zoning Regulations (NZR), as amended 2009 p29) These regulations may be downloaded here:

<http://norwich.vt.us/wp-content/uploads/2012/06/Norwich-Zoning-Regulations-Amended-07-01-09.pdf>

Sincerely,

Rod Francis  
Planning Director  
Zoning Administrator  
Town of Norwich

--

O'Meara Solar  
[www.omearasolar.com](http://www.omearasolar.com)  
802-522-2381

--

O'Meara Solar  
[www.omearasolar.com](http://www.omearasolar.com)  
802-522-2381

## Herb Durfee

---

**From:** Herb Durfee  
**Sent:** Friday, September 18, 2020 9:58 AM  
**To:** Claudette Brochu; John Langhus; Mary Layton; 'rgere@mac.com'; Roger Arnold  
**Cc:** Miranda Bergmeier; 'Rod Francis'; Pam Mullen; 'Melissa Horwitz'  
**Subject:** RE: FW: 9-23-20 Selectboard Agenda and Packet  
**Attachments:** PUC\_PortallInfo\_MargoAveryTrust.pdf

Claudette,

Following is the PUC link to the Margo Avery Trust (applicant) "case details".

<https://epuc.vermont.gov/?q=node/64/151449/FV-Case%20Summary-Portal>

Attached, from that link, are the summary details from each of the portal's "tabs" (i.e., Summary, People, Schedule, Commission-Issued Documents, Prefiled Testimony/Exhibits/Affidavits, All Other Documents, Public Comment, and Case Log). While I didn't include all the gory details, I did print the Norwich Zoning Administrator's e-mail string with Darren O'Meara and the site plan on file. If you wish to dive further into the application's details, once you're in the portal, wherever you see a "magnifying glass inside a box" that means there is a document. To view that document, click on the magnifying glass.

Note the attachment has some blank pages. That's because I scanned the information back-to-back; some pages were single-sided and others were double-sided. So, nothing is missing in the scan.

Also, I checked the 2020 minutes of the PC posted on the Town webpage. Unless I missed something, I don't believe the PC discussed this application. But, I'll let Rod/Melissa correct me, if I'm in error.

This e-mail and its attachment will be included in next week's revised/amended packet.

Herb

Herbert A. Durfee, III  
Town Manager  
Town of Norwich  
PO Box 376  
Norwich, VT 05055  
802-649-1419 ext. 102  
802-698-3000 (cell)  
802-649-0123 (fax)

**From:** claudette brochu [<mailto:cbrochu30@gmail.com>]  
**Sent:** Thursday, September 17, 2020 9:48 PM  
**To:** Herb Durfee  
**Cc:** Roger Arnold; claudette brochu  
**Subject:** Re: FW: 9-23-20 Selectboard Agenda and Packet

Hi Herb,

With my very quick first pass at reviewing the packet material, I noted the Tucker Hill solar array proposal. I had seen mention of this in PC minutes and remembered that this project is sited in the Ridgeline protected area of the Town Plan. I have sent an email to Melissa to get a copy of the PC minutes or some clarity on if any

decision was made by the PC to either support this project or to provide testimony to the PUC in opposition. If this material can be part of the packet revision, I think it would be helpful.

This project is clearly part of the message in John's memo but also will be a test of the Town Plan. What is the purpose of a TP if the protections in place to preserve the ridgelines and forests are not enforced?

C

Please note that any reply or response to this email is subject to the disclosure provisions under the Vermont Open Meeting Law and Public Records Act..

On Thu, Sep 17, 2020 at 3:45 PM Herb Durfee <[HDurfee@norwich.vt.us](mailto:HDurfee@norwich.vt.us)> wrote:

Board Members,

Below is the link to you agenda/packet. There will be a revised/amended packet next week.

Herb

Herbert A. Durfee, III

Town Manager

Town of Norwich

PO Box 376

Norwich, VT 05055

802-649-1419 ext. 102

802-698-3000 (cell)

802-649-0123 (fax)

---

**From:** Pam Mullen  
**Sent:** Thursday, September 17, 2020 2:52 PM  
**To:** Pam Mullen  
**Subject:** FW: 9-23-20 Selectboard Agenda and Packet

Selectboard Agenda and Packet for Wednesday, September 23, 2020 is up on the Town Website at:

Agenda: [http://norwich.vt.us/wp-content/uploads/2020/09/Selectboard-Agenda-09\\_23\\_2020.pdf](http://norwich.vt.us/wp-content/uploads/2020/09/Selectboard-Agenda-09_23_2020.pdf)

Packet: <http://norwich.vt.us/wp-content/uploads/2020/09/Selectboard-Packet-09-23-2020.pdf>

Please note that it is anticipated that the Packet will be revised next week.

Pam Mullen for Miranda Bergmeier  
Assistant to the Town Manager  
Town of Norwich  
P.O. Box 376  
Norwich, VT 05055  
802-649-1419 x101

Please note that any response or reply to this electronic message may be subject to disclosure as a public record under the Vermont Public Records Act.





# Vermont Public Utility Commission

Public Comment

## Case Details

Select Action



**20-2276-NM**

**Margo Avery Trust 29.4 kW solar NM in  
Norwich**

Open Case Age: 34

Regulatory / Net-Metering CPG Application: Open

Date filed: 08/18/20

Hearing Officer

Date Administratively Complete: 09/3/20

Margo Avery Trust [Applicant]

Green Mountain Power Corporation [Utility  
Company]

Electric

1

Location(s): Norwich

Summary

People

Schedule

Commission-Issued Documents

Prefiled Testimony, Exhibits, Affidavits

All Other Documents

Public Comment

Case Log

### Summary-Portal

#### Caption:

Application of Margo Avery Trust for a certificate of public good for a 29.4 kW solar net-metered electric power system in Norwich, Vermont

### Net Metering

Date Filed ▲	Service Address	Consumption Meter No.	Group	Other NM Systems On Parcel	Existing CPG No.	Adv. Notice Ref. No.	Other Related Case No.
09/03/2020	297 Tucker Hill Norwich, VT 05055	E15064111	No	No		<u>20-1635-AN</u> (Closed)	

### Generation Type(s)

Generation Type	Generation Size	Installation Type	Preferred Site(s)	Near Customer Load Info
Solar	29.40	Ground Mount	Not a Preferred Site, Near customer load	E15064111, 100% of the project's output is going to the customers load.

+ Petitioner/Applicant

System Owner(s)/Installer(s) and/or Property Owner(s)ptl

<b>Name</b>	<b>Generation Type</b>	<b>Address</b>	<b>Telephone</b>	<b>Email</b>	<b>Status</b>
O'Meara, Darren, System Installer	Solar (29.4 Kilowatts)	<b>Mailing</b> PO BOX 151 WEST TOPSHAM, VT 05086	<b>Mobile:</b> 8025222381	<b>Primary Email:</b> omearasolar@gmail.com	Active

Copyright © Journal Technologies, USA. All rights reserved.



# Vermont Public Utility Commission

Public Comment

## Case Details

Select Action



**20-2276-NM**

**Margo Avery Trust 29.4 kW solar NM in  
Norwich**

Open Case Age: 34

Regulatory / Net-Metering CPG Application: Open

Date filed: 08/18/20

Hearing Officer

Date Administratively Complete: 09/3/20

Margo Avery Trust [Applicant]

Green Mountain Power Corporation [Utility  
Company]

Electric

1

Location(s): Norwich

Summary

People

Schedule

Commission-Issued Documents

Prefiled Testimony, Exhibits, Affidavits

All Other Documents

Public Comment

Case Log

### People-Portal

#### Parties/Participants

Name(s)	Address	Telephone	Email	Status
Margo Avery Trust [APP]	<b>Mailing</b> 2049 Century Park East Suite 1400 Los Angeles, CA 90067	<b>Work:</b> (310) 315- 6242	<b>Primary Email:</b> rhimesteam@savco.com	Active
Green Mountain Power Corporation [UTI]	<b>Mailing</b> 163 Acorn Lane Colchester, VT 05446	<b>Work:</b> (802) 655- 8768		Active
Net-Metering Notices, Green Mountain ...			<b>Primary Email:</b> DR@greenmountainpower.com	Active

Name(s)	Address	Telephone	Email	Status
Vermont Department of Public Service [P]	<b>Mailing</b> 112 State Street, 3rd Floor Montpelier, VT 05620			Active
Director of Public Advocacy, Vermont ...			<b>Primary Email:</b> DPS-PA@vermont.gov	Active
Vermont Agency of Natural Resources [P]	<b>Mailing</b> 1 National Life Drive, Davis 2 Montpelier, VT 05620			Active
General Counsel, Vermont Agency of Na...			<b>Primary Email:</b> anr.notice@vermont.gov	Active

### Entities Receiving Notice

Name(s)	Address	Telephone	Email
Vermont Division for Historic Preservation [AGEN]	<b>Mailing</b> One National Life Dr, Floor 6 Montpelier, VT 05620		
Senior Historic Preservation Review C...			<b>Primary Email:</b> accd.projectreview@vermont.g
Vermont Agency of Agriculture, Food and Markets [AGEN]	<b>Mailing</b> 116 State Street, Drawer 20 Montpelier, VT 05620		
Secretary AAFM, Vermont Agency of Agr...			<b>Primary Email:</b> AGR.Notice@vermont.gov



# Vermont Public Utility Commission

Public Comment

## Case Details

Select Action

**20-2276-NM**

**Margo Avery Trust 29.4 kW solar NM in  
Norwich**

Open Case Age: 34

Regulatory / Net-Metering CPG Application: Open

Date filed: 08/18/20

Hearing Officer

Date Administratively Complete: 09/3/20

Margo Avery Trust [Applicant]

Green Mountain Power Corporation [Utility  
Company]

Electric

1

Location(s): Norwich

Summary

People

Schedule

Commission-Issued Documents

Prefiled Testimony, Exhibits, Affidavits

All Other Documents

Public Comment

Case Log

Schedule-Portal

Hearing/Events

Date/Times	Description	Location	Event Status	Commission Personnel	Result	Result Date	Event End Date/Time
	Net-Metering CPG Application						

Case Schedule

Due Date	Name	Related to	Filed by
10/05/2020	Due Date for Comments or Objection	20-2276-NM	



# Vermont Public Utility Commission

Public Comment

## Case Details

Select Action



**20-2276-NM**

**Margo Avery Trust 29.4 kW solar NM in  
Norwich**

Open Case Age: 34

Regulatory / Net-Metering CPG Application: Open

Date filed: 08/18/20

Hearing Officer

Date Administratively Complete: 09/3/20

Margo Avery Trust [Applicant]

Green Mountain Power Corporation [Utility  
Company]

Electric

1

Location(s): Norwich

Summary

People

Schedule

Commission-Issued Documents

Prefiled Testimony, Exhibits, Affidavits

All Other Documents

Public Comment

Case Log

### Commission-Issued Documents

#### Commission-Issued Documents Other Than Acknowledgements of Public Comments

Issued	Name of Document	Title	Status	Seal Type	View Document
	Net-Metering CPG Application				
09/03/2020	Notice of Complete Petition	Memorandum re: Notice of Complete Application	Issued	Public	
08/27/2020	Net-Metering Application Incomplete Memo	Memorandum Re: Incomplete Application	Issued	Public	

#### Commission-Issued Documents - Acknowledgements of Public Comments

Issued	Name of Document	Title	Status	Seal Type	View Document
	Net-Metering CPG Application				





# Vermont Public Utility Commission

Public Comment

## Case Details

Select Action

**20-2276-NM**

**Margo Avery Trust 29.4 kW solar NM in  
Norwich**

Open Case Age: 34

Regulatory / Net-Metering CPG Application: Open

Date filed: 08/18/20

Hearing Officer

Date Administratively Complete: 09/3/20

Margo Avery Trust [Applicant]

Green Mountain Power Corporation [Utility  
Company]

Electric

1

Location(s): Norwich

Summary

People

Schedule

Commission-Issued Documents

Prefiled Testimony, Exhibits, Affidavits

All Other Documents

Public Comment

Case Log

Prefiled Testimony, Exhibits, Affidavits

Prefiled Testimony, Exhibits, Affidavits

Filed / Name of Document	Number	Title	Type	Filed By	Sponsored By	Status	Seal Type	View Document
Net-Metering CPG Application								
08/18/20 Exhibit		zoning admin	Response to Comments Received After 45-Day Advance Notice	Margo Avery Trust [APP]		Filed	Public	
08/18/20 Exhibit		Site Plan	Site Plan	Margo Avery Trust [APP]		Filed	Public	



Filed / Name of Document	Number	Title	Type	Filed By	Sponsored By	Status	Seal Type	View Document
08/18/20 Exhibit		Wetland Ecologist	Wetland documentation	Margo Avery Trust [APP]		Filed	Public	

Copyright © Journal Technologies, USA. All rights reserved.

---

**Re: Margo Avery Trust 297 Tucker Hill Rd, Norwich**

1 message

---

**Rod Francis** <norwichvtplanner@gmail.com>  
To: Darren O'Meara <omearasolar@gmail.com>

Wed, Jul 29, 2020 at 8:09 AM

Darren,

The Town has not needed a visual impact analysis for such a project since this Town Plan came into effect in March 2020.

The recent application from Norwich Technologies on Turnpike Road did include a visual impact analysis. This information may be available through the PUC (which means it would be in the public domain now). We don't hold the information because this part of the application was done to resolve issues with an abutter, the Town was not a party to the process, and therefore the work is not ours to share.

However, there are a few critical points to be made:

- The Turnpike Road site met the towns 'preferred site' status criteria
- The visual impact analysis and conclusions reached in regard to 'character of the area' used the so-called 'Quechee Test' which is NOT the threshold for analyzing visual impact in the Norwich Ridgeline Protection Overlay District

Rod Francis  
Planning Director  
Zoning Administrator  
Town of Norwich

On Tue, Jul 28, 2020 at 9:44 PM Darren O'Meara <omearasolar@gmail.com> wrote:

Hi Rod,

I understand. Do you happen to have a similar visual impact analysis that has been submitted to the town in the past, that I could look at?

Thanks,  
Darren

On Tue, Jul 28, 2020 at 9:31 PM Rod Francis <norwichvtplanner@gmail.com> wrote:

Darren,

I am afraid that is not possible.

Even before covid-19 this would not be a solution. It is not a matter of my observation in the field.

You will need a technical visual impact analysis that demonstrates that any visual impact meets the standards set forth in the pertinent section of the Zoning Regulations I referenced. You can talk with your landscape architect about the specific methods used to conduct this work. There are companies that specialize in this work also.

It is up to you and the property owners to decide whether the project is viable without 'preferred site' status being conferred by the Town, and/or the expense of establishing that there is no meaningful visual impact.

Rod Francis  
Planning Director  
Zoning Administrator  
Town of Norwich

On Tue, Jul 28, 2020 at 9:03 PM Darren O'Meara <omearasolar@gmail.com> wrote:

Hi Rod,

Thank you for sending this along. Could you meet me at the proposed site to determine whether the location of the array meets the intent of the Town's preferred site criteria? It is very well hidden, and sits below the ridgeline.

Thanks,  
Darren

On Tue, Jul 28, 2020 at 2:52 PM Rod Francis <norwichvtplanner@gmail.com> wrote:

Darren,

I acknowledge receipt of your packet in the mail providing 45 day notice pursuant to 30 VSA Section 8010 and 248 and Public Utility Commission Rule 5.107 (B).

The Norwich Town Plan adopted March 7, 2020 contains the following policy on page 22:

3-2.h For solar generation projects sized from 15kW to 500kW the presumption is that all of Norwich meets the Public Utility Commission definition of 'preferred site', notwithstanding the existing areas of local concern including the Ridgeline Protection Overlay Area, Shoreline Protection Overlay Area and the historic village district as identified in the Norwich Land Use Regulations. (emphasis added)

As you can see from the accompanying map, the project is proposed for a parcel that lies in the Ridgeline Protection Overlay Area. The project is not located in an area of town where 'preferred site' status can be conferred.

The level of documentation provided prevents me from concluding that the development is not visible from a public road, or other standards as set out in the Norwich Zoning Regulations (NZR), as amended 2009 p29) These regulations may be downloaded here:

[http://norwich.vt.us/wp-content/uploads/2012/06/Norwich-Zoning-Regulations\\_Amended\\_07-01-09.pdf](http://norwich.vt.us/wp-content/uploads/2012/06/Norwich-Zoning-Regulations_Amended_07-01-09.pdf)

Sincerely,

Rod Francis  
Planning Director  
Zoning Administrator  
Town of Norwich

--

O'Meara Solar  
www.omearasolar.com  
802-522-2381

--

O'Meara Solar  
www.omearasolar.com  
802-522-2381

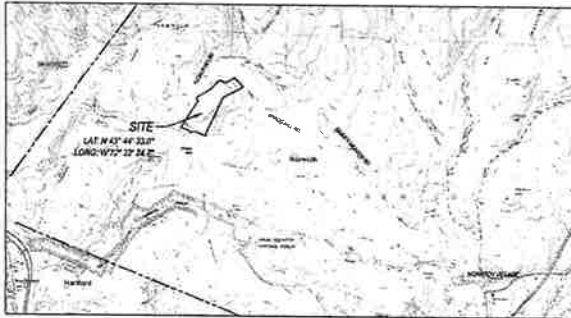

LOCATION MAP  
SCALE: 1" = 3500'

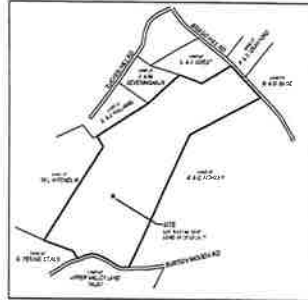

INTERMEDIATE LOCUS  
SCALE: 1" = 1000'

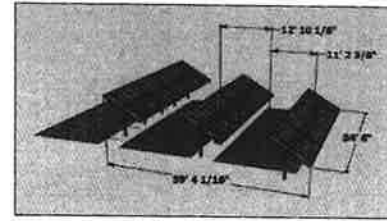

PROPOSED ARRAY LAYOUT  
NOT TO SCALE

- NOTES:**
- ASPECTS OF THIS PLAN ARE APPROXIMATE AND DERIVED FROM AERIAL PHOTOGRAPHY (2018 PHOTO).
  - THE HORIZONTAL COORDINATE SYSTEM IS BASED ON NAD83 VERMONT STATE PLANE COORDINATES, ZONE 4000. THE VERTICAL DATUM IS NAVD 83.
  - EXISTING GROUND CONTOURS ARE BASED ON A TOPOGRAPHIC SITE PLAN DATED 17 JULY 2018 AS PROVIDED BY SHEPARD BUTLER LANDSCAPE ARCHITECTS.
  - THIS IS NOT A BOUNDARY SURVEY. THE PARCEL BOUNDARIES SHOWN HEREON ARE BASED ON THE TAX MAPS OF THE TOWN OF NORWICH.
  - LOCATIONS OF EXISTING UTILITIES ARE APPROXIMATE ONLY. CONTRACTOR SHALL CONTACT DIG-SAFE PRIOR TO COMMENCING ANY EARTH DISTURBING ACTIVITIES.

**PROJECT INFORMATION**

- CURRENT USE OF PROPERTY**
- THE PROPOSED ARRAY IS TO BE LOCATED IN AN EXISTING UNUSED AND OVERGROWN PASTURE.

- CLEARING**
- THREE INDIVIDUAL TREES AND AN ADDITIONAL 1000 sq. ft. OF BRUSH AND TREE REMOVAL.

- DISTURBED SOIL**
- ELECTRICAL SERVICE & PEDESTALS = 2740 sq. ft.
  - ARRAY FOOTPRINT = 3235 sq. ft.
  - TOTAL = 5975 sq. ft.

- PRIMARY AGRICULTURAL SOILS (PALS)**
- NO PALS EXISTING IN THE VICINITY OF THE PROJECT.

- WETLANDS AND/OR WET AREAS**
- NO MAPPED WETLANDS OR OBSERVED WET AREAS EXIST IN THE VICINITY OF THE PROJECT.

- IMPERVIOUS AREA**
- NO IMPERVIOUS SURFACES ARE PROPOSED.

- EROSION CONTROL**
- THE CONTAINED EXCAVATION (TRENCHING) NECESSARY FOR THE INSTALLATION OF THE ELECTRICAL SERVICE LINE AND THE ARRAY FOOTINGS REQUIRE NO EROSION CONTROL MEASURES.
  - MATERIAL STOCKPILES, IF ANY, WILL BE SURROUNDED BY SILTFENCE IF TO BE LEFT UNWORKED MORE THAN 5 DAYS.
  - FINAL DISTURBED SURFACES WILL BE SEEDED AND MULCHED OR OTHERWISE RESTORED TO THE EXISTING CONDITION.

- ELECTRICAL SERVICE**
- THE EXISTING 400 AMP ELECTRICAL SERVICE TO THE RESIDENCE IS ADEQUATE TO SERVE THE PROPOSED 16-KW METERED PROJECT.
  - A 200 AMP SERVICE LINE FROM THE EXISTING RESIDENTIAL SERVICE TO THE ARRAY, ALONG WITH APPROPRIATE INVERSION, METERING AND DISCONNECTION EQUIPMENT, WILL BE INSTALLED.

- LIGHTING, LANDSCAPING & FENCING**
- NO LIGHTING, LANDSCAPING OR FENCING IS PROPOSED.

- ACT 250 JURISDICTION**
- NO ACT 250 JURISDICTION IS ATTACHED TO THE SUBJECT PROPERTY.

**PROPERTY INFORMATION**  
OWNER: MARGO AVERY TRUST  
SHONDA RHIMES, TRUSTEE  
ADDRESS: 297 TUCKER HILL ROAD  
NORWICH, VT 05055  
SPAN: 450-142-13219

REV	DESCRIPTION	DATE

O'Meara Solar

SITE PLAN  
PROPOSED SOLAR ARRAY  
MARGO AVERY TRUST  
297 TUCKER HILL ROAD NORWICH, VERMONT

SCALE: 1" = 40' DATE: 6/24/2019 PROJECT: 2020-073 DRAWN: EJA

CHECKED: MJC TYPED: N/A

301 North Main Street, Suite 1  
Norwich, VT 05055  
802-477-9863

Chase & Chase  
Surveyors & Septic  
Designers, Inc.

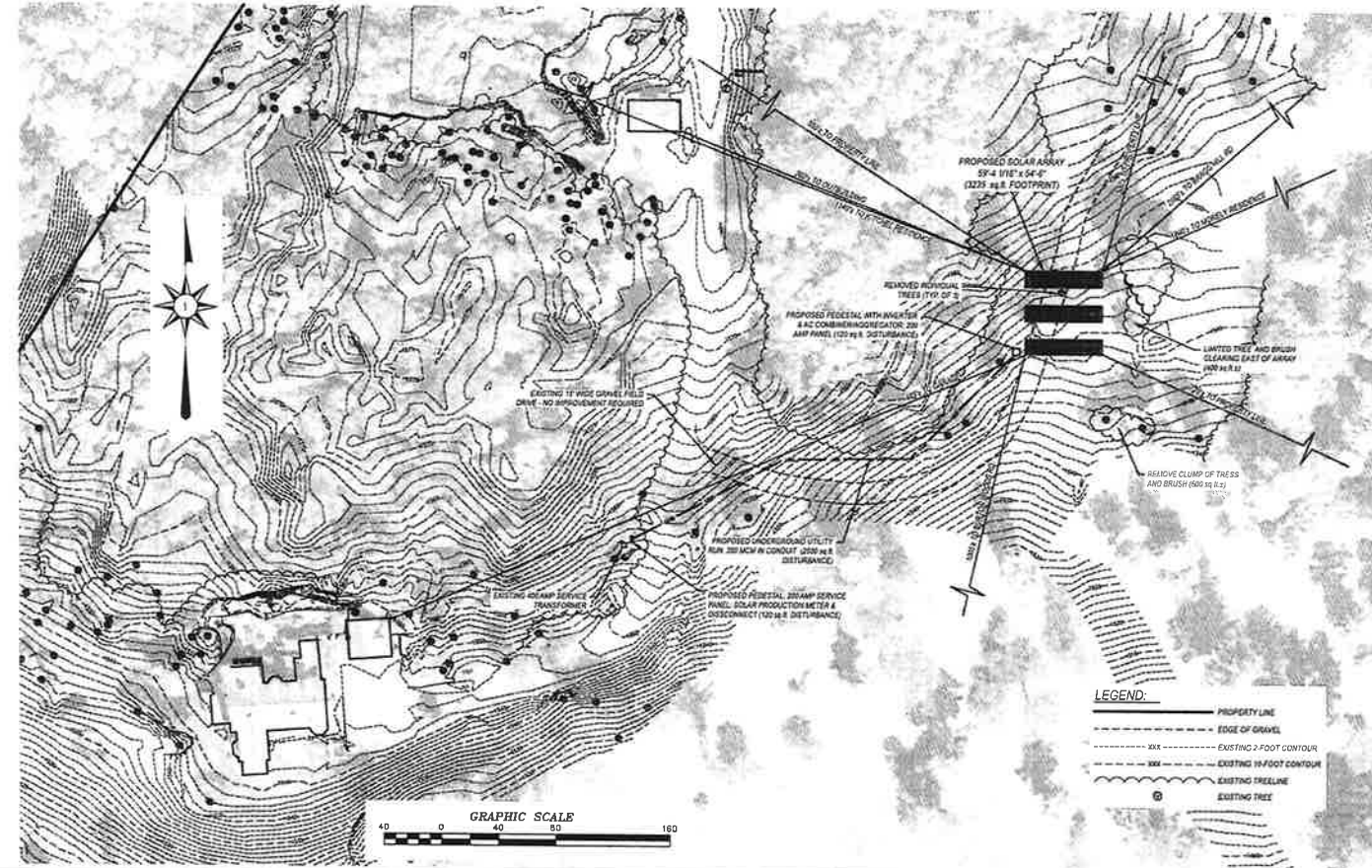

- LEGEND:**
- PROPERTY LINE
  - EDGE OF GRAVEL
  - EXISTING 2-FOOT CONTOUR
  - EXISTING 10-FOOT CONTOUR
  - EXISTING FREELINE
  - EXISTING TREE



# Vermont Public Utility Commission

Public Comment

## Case Details

Select Action



**20-2276-NM**

**Margo Avery Trust 29.4 kW solar NM in  
Norwich**

Open Case Age: 34

Regulatory / Net-Metering CPG Application: Open

Date filed: 08/18/20

Hearing Officer

Date Administratively Complete: 09/3/20

Margo Avery Trust [Applicant]

Green Mountain Power Corporation [Utility  
Company]

Electric

1

Location(s): Norwich

Summary

People

Schedule

Commission-Issued Documents

Prefiled Testimony, Exhibits, Affidavits

All Other Documents

Public Comment

Case Log

### All Other Documents

#### Documents in Initial Filing other than Motions, Prefiled Testimony and Exhibits

Filed	Name of Document	Document Title	Filed By	Status	Seal Type	View Document
	Net-Metering CPG Application					
09/03/2020	Application Form - Net-Metering		Margo Avery Trust [APP]	Filed	Public	
08/18/2020	Certificate of Service		Margo Avery Trust [APP]	Filed	Public	
08/18/2020	Department/Commission Fee Form		Margo Avery Trust [APP]	Filed	Public	

### All Other Documents Filed By Parties

Filed/Name of Document	Document Title	Filed by	Status	Seal Type	V D
○ Net-Metering CPG Application					
○ 09/3/20 New Filing					
○ 09/3/20 Response to Commission or Hearing Officer questions	Preferred Site Clarification	Margo Avery Trust [APP]	Filed	Public	☒
○ 08/31/20 New Filing					
○ 08/31/20 Certification of compliance with advance notice requi...	Certification of Advance Notice	Margo Avery Trust [APP]	Filed	Public	☒



# Vermont Public Utility Commission

Public Comment

## Case Details

Select Action

**20-2276-NM**

**Margo Avery Trust 29.4 kW solar NM in  
Norwich**

Open Case Age: 34

Regulatory / Net-Metering CPG Application: Open

Date filed: 08/18/20

Hearing Officer

Date Administratively Complete: 09/3/20

Margo Avery Trust [Applicant]

Green Mountain Power Corporation [Utility  
Company]

Electric

1

Location(s): Norwich

Summary

People

Schedule

Commission-Issued Documents

Prefiled Testimony, Exhibits, Affidavits

All Other Documents

Public Comment

Case Log

Public Comments-Portal



# Vermont Public Utility Commission

Public Comment

## Case Details

Select Action

**20-2276-NM**

**Margo Avery Trust 29.4 kW solar NM in  
Norwich**

Open Case Age: 34

Regulatory / Net-Metering CPG Application: Open

Date filed: 08/18/20

Hearing Officer

Date Administratively Complete: 09/3/20

Margo Avery Trust [Applicant]

Green Mountain Power Corporation [Utility  
Company]

Electric

1

Location(s): Norwich

Summary

People

Schedule

Commission-Issued Documents

Prefiled Testimony, Exhibits, Affidavits

All Other Documents

Public Comment

Case Log

### Register of Actions-Portal

#### Register of Actions

##### System

Date ▲

Date Filed or Issued / Action

- 09/03/2020 09/3/20 Application Form - Net-Metering filed by Margo Avery Trust [APP]
- 09/03/2020 Sent email notification regarding the creation of SubCase 'Net-Metering CPG Application' to Margo Avery Trust [rhimesteam@savco.com], Darren O'Meara [omearasolar@gmail.com], Director of Public Advocacy [DPS-PA@vermont.gov], General Counsel [anr.notice@vermont.gov], Senior Historic Preservation Review Coordinator Survey Archaeologist [accd.projectreview@vermont.gov], Secretary AAFM [AGR.Notice@vermont.gov], Net-Metering Notices [DR@greenmountainpower.com]
- 09/03/2020 Status for SubCase 'Net-Metering CPG Application' changed from 'Pending Completion' to 'Open'
- 09/03/2020 Sent email notification regarding the issuance of 'Notice of Complete Petition Document' to Margo Avery Trust [rhimesteam@savco.com], Darren O'Meara [omearasolar@gmail.com], Director of Public Advocacy [DPS-PA@vermont.gov], General Counsel [anr.notice@vermont.gov]
- 09/03/2020 09/3/20 Notice of Complete Petition Memorandum re: Notice of Complete Application
- 09/03/2020 Sent email notification regarding filing of 'Response to Commission or Hearing Officer questions Document' to Margo Avery Trust [rhimesteam@savco.com], Darren O'Meara [omearasolar@gmail.com]



**System****Date ▲****Date Filed or Issued / Action**

08/03/2020 09/3/20 Response to Commission or Hearing Officer questions Preferred Site Clarification filed by Margo Avery Trust [APP]

08/30/2020 Sent email notification regarding filing of 'Certification of compliance with advance notice requirements Document' to Margo Avery Trust[rhimesteam@savco.com], Darren O'Meara[omearasolar@gmail.com]

08/30/2020 08/31/20 Certification of compliance with advance notice requirements Certification of Advance Notice filed by Margo Avery Trust [APP]

08/27/2020 Sent email notification regarding the issuance of 'Net-Metering Application Incomplete Memo Document' to Margo Avery Trust[rhimesteam@savco.com]

08/27/2020 08/27/20 Net-Metering Application Incomplete Memo Memorandum Re: Incomplete Application

08/27/2020 Sent email notification regarding new status 'Pending Completion' of SubCase 'Net-Metering CPG Application' to Margo Avery Trust [rhimesteam@savco.com], Darren O'Meara [omearasolar@gmail.com]

08/27/2020 Status for SubCase 'Net-Metering CPG Application' changed from 'eFiled' to 'Pending Completion'

08/15/2020 08/18/20 Application Form - Net-Metering filed by Margo Avery Trust [APP]

08/15/2020 Sent email notification regarding filing of 'Exhibit Document' to Margo Avery Trust[rhimesteam@savco.com], Darren O'Meara[omearasolar@gmail.com]

08/15/2020 Sent email notification regarding filing of 'Exhibit Document' to Margo Avery Trust[rhimesteam@savco.com], Darren O'Meara[omearasolar@gmail.com]

08/15/2020 Sent email notification regarding filing of 'Exhibit Document' to Margo Avery Trust[rhimesteam@savco.com], Darren O'Meara[omearasolar@gmail.com]

08/15/2020 SubCase 'Net-Metering CPG Application' was inserted

08/15/2020 08/18/20 Department/Commission Fee Form filed by Margo Avery Trust [APP]

08/15/2020 08/18/20 Certificate of Service filed by Margo Avery Trust [APP]

08/15/2020 08/18/20 Exhibit filed on behalf of Margo Avery Trust [APP]

08/15/2020 08/18/20 Exhibit filed on behalf of Margo Avery Trust [APP]

08/15/2020 08/18/20 Exhibit filed on behalf of Margo Avery Trust [APP]

08/15/2020 Regulatory case 20-2276-NM, Application of Margo Avery Trust for a certificate of public good for a 29.4 kW solar net-metered electric power system in Norwich, Vermont, (Electric) filed

ADDITIONAL  
9

09/18/20  
09:01 am

Town of Norwich General Ledger  
Balance Sheet Current Year - Period 2 Aug  
General

Account	Curr Yr Pd 2 Aug Encumbrances	Curr Yr Pd 2 Aug Actual
<b>ASSET</b>		
<b>01-1-001 CASH</b>		
01-1-001001.00 PETTY CASH-RECEIPTS DRWR	0.00	50.00
01-1-001002.00 PETTY CASH-POLICE DEPT	0.00	100.00
01-1-001003.00 PETTY CASH-RECREATION	0.00	100.00
01-1-001004.00 PETTY CASH-SOLID WASTE	0.00	100.00
01-1-001005.00 PETTY CASH-TOWN CLERK	0.00	100.00
01-1-001100.00 CASH-MASCOMA GENL FUND	0.00	9,792,424.29
01-1-001102.00 CASH-MASCOMA RECREATION	0.00	4,811.52
01-1-001104.00 CASH-MASCOMA FISH & GAME	0.00	535.16
<b>Total CASH</b>	<b>0.00</b>	<b>9,798,220.97</b>
<b>01-1-002 INVESTMENTS</b>		
<b>Total INVESTMENTS</b>	<b>0.00</b>	<b>0.00</b>
<b>01-1-003 RECEIVABLES</b>		
<b>01-1-0030 ACCOUNTS RECEIVABLE</b>		
01-1-003015.00 ACCTS REC-CEMETERY COMM	0.00	-11.90
01-1-003023.00 A/R IRS	0.00	13,451.35
<b>Total ACCOUNTS RECEIVABLE</b>	<b>0.00</b>	<b>13,439.45</b>
<b>01-1-0031 GRANT RECEIVABLE</b>		
01-1-003108.00 GRANT REC-HIGHWAY DEPT	0.00	1,000.00
01-1-003110.00 GRANT REC-PLANNING DEPT.	0.00	5,590.00
<b>Total GRANT RECEIVABLE</b>	<b>0.00</b>	<b>6,590.00</b>
<b>01-1-0032 NOTES RECEIVABLE</b>		
<b>Total NOTES RECEIVABLE</b>	<b>0.00</b>	<b>0.00</b>
<b>01-1-0034 TAXES RECEIVABLE</b>		
01-1-003401.00 CURRENT TAX RECVBLE	0.00	7,999,490.81
01-1-003402.00 DEL PROP TAXES RECEIVABLE	0.00	162,640.70
01-1-003403.00 TAX INTEREST RECV	0.00	43,649.09
01-1-003404.00 PENALTY RECEIVABLE	0.00	12,990.36
<b>Total TAXES RECEIVABLE</b>	<b>0.00</b>	<b>8,218,770.96</b>
<b>Total RECEIVABLES</b>	<b>0.00</b>	<b>8,238,800.41</b>
<b>01-1-004 OTHER ASSETS</b>		
01-1-004102.00 PREPAID EXPENSES	0.00	5,136.02
01-1-004104.00 INVENTORY	0.00	36,804.23
<b>Total OTHER ASSETS</b>	<b>0.00</b>	<b>41,940.25</b>

Account	Curr Yr Pd 2 Aug Encumbrances	Curr Yr Pd 2 Aug Actual
01-1-090000.00 DUE FROM/TO OTHER FUND	0.00	-2,174,397.96
<b>Total Asset</b>	<b>0.00</b>	<b>18,904,863.67</b>
<b>LIABILITY</b>		
<b>01-2-001 ACCOUNTS PAYABLE</b>		
01-2-001101.01 FICA TAX DUE TO EMPLOYEE	0.00	101.84
01-2-001117.00 UNION DUES PAYABLE	0.00	690.00
01-2-001120.00 EMPLOYEE JUDGEMENT ORDER	0.00	75.00
01-2-001121.00 VT ANIMAL RETURN	0.00	1,825.00
01-2-001122.00 DUE TO VT-FISH & GAME	0.00	166.70
01-2-001122.01 VT FISH & GAME GIFT CERTI	0.00	97.00
01-2-001123.00 SCHOOL DISTRICT TAX	0.00	-500,000.00
01-2-001124.00 DUE TO VT-VITAL RECORDS	0.00	840.00
01-2-001125.00 DUE TO GUVSWMD-COUPONS	0.00	-3,217.20
01-2-001125.10 DUE TO GUVSWMD-STICKERS	0.00	1,378.00
01-2-001126.00 VISION SERV PLAN-PAYROLL	0.00	82.47
01-2-001128.00 DUE TO WINDSOR COUNTY	0.00	-29,641.50
01-2-001148.00 TAX OVERPAYMENTS	0.00	14,377.21
01-2-001149.00 TAX CLEARING ACCOUNT	0.00	-458,508.93
01-2-001150.00 VENDORS PAYABLE	0.00	12,290.89
<b>Total ACCOUNTS PAYABLE</b>	<b>0.00</b>	<b>-959,443.82</b>
<b>01-2-002 GRANT LIABILITY</b>		
<b>Total GRANT LIABILITY</b>	<b>0.00</b>	<b>0.00</b>
<b>01-2-003 OTHER LIABILITIES</b>		
01-2-003017.00 MSB 5 YEAR LOAN	0.00	-55,817.09
<b>Total OTHER LIABILITIES</b>	<b>0.00</b>	<b>-55,817.09</b>
<b>01-2-004 DEFERRED REVENUES</b>		
01-2-004001.00 DEFERRED REV-TAXES	0.00	196,334.38
01-2-004004.00 DEFERRED REV-GRANTS	0.00	6,590.00
<b>Total DEFERRED REVENUES</b>	<b>0.00</b>	<b>202,924.38</b>
<b>Total Liability</b>	<b>0.00</b>	<b>-812,336.23</b>
<b>FUND BALANCE</b>		
<b>01-3-0011 RESERVE-FUND BALANCE</b>		
<b>Total RESERVE-FUND BALANCE</b>	<b>0.00</b>	<b>0.00</b>

Account	Curr Yr Pd 2 Aug Encumbrances	Curr Yr Pd 2 Aug Actual
<b>01-3-0013 UNRESTRICTED FUNDS</b>		
01-3-001300.00 GENERAL FUND BAL-UNREST	0.00	868,591.54
<b>Total UNRESTRICTED FUNDS</b>	<b>0.00</b>	<b>868,591.54</b>
<b>Total Prior Years Fund Balance</b>	<b>0.00</b>	<b>868,591.54</b>
Fund Balance Current Year	0.00	15,848,308.36
<b>Total Fund Balance</b>	<b>0.00</b>	<b>16,716,899.90</b>
<b>Total Liability, Reserves, Fund Balance</b>	<b>0.00</b>	<b>18,904,563.67</b>

09/17/20  
03:24 pm

Town of Norwich General Ledger  
Current Yr Pd: 2 - Budget Status Report  
General

ADDITIONAL  
⑨

Account	Budget	Actual	% of Budget
<b>01-4-0000 PROPERTY TAX REVENUES</b>			
01-4-000001.00 TOWN PROPERTY TAX	3,538,516.00	16,434,813.40	464.45%
01-4-000002.00 PROPERTY TAX OTHER MONETA	552,868.00	0.00	0.00%
01-4-000005.00 RAILROAD TAX	0.00	0.00	0.00%
01-4-000010.00 VT LAND USE TAX	187,117.00	0.00	0.00%
01-4-000014.00 PROP TAX INTEREST	30,000.00	3,036.94	10.12%
01-4-000015.00 PROP TAX COLL FEE	20,000.00	-245.36	-1.23%
<b>Total PROPERTY TAX REVENUES</b>	<b>4,328,501.00</b>	<b>16,437,604.98</b>	<b>379.75%</b>
<b>01-4-0001 LICENSE &amp; PERMIT</b>			
01-4-000101.00 LIQUOR LICENSE	600.00	0.00	0.00%
01-4-000103.00 DOG LICENSE	2,750.00	110.00	4.00%
01-4-000107.00 HUNT & FISH LICENSE	200.00	0.00	0.00%
01-4-000109.00 PEDDLER LICENSE	25.00	0.00	0.00%
01-4-000120.00 BLDG/DEVEL PERMIT	3,500.00	2,330.18	66.58%
01-4-000130.00 LAND POSTING PERMIT	175.00	0.00	0.00%
<b>Total LICENSE &amp; PERMIT</b>	<b>7,250.00</b>	<b>2,440.18</b>	<b>33.66%</b>
<b>01-4-0002 INTERGOVERNMENTAL</b>			
01-4-000201.00 VT HIWAY GAS TAX	153,000.00	0.00	0.00%
01-4-000202.00 VT ACT 60	15,300.00	0.00	0.00%
01-4-000206.00 ST. OF VT. LISTER TRAININ	0.00	0.00	0.00%
01-4-000208.00 PILOT	12,500.00	0.00	0.00%
01-4-000210.00 VT NATURAL RESRCS	2,800.00	0.00	0.00%
01-4-000211.00 EDUCATION TAX REFUND-2010	0.00	0.00	0.00%
01-4-000212.00 VT EDUC FUND .5% FEE	0.00	0.00	0.00%
01-4-000214.00 EDUC TAX RETAINER .225 o	27,000.00	0.00	0.00%
01-4-000216.00 LATE FEES-REVISED BILLS	0.00	0.00	0.00%
<b>Total INTERGOVERNMENTAL</b>	<b>210,600.00</b>	<b>0.00</b>	<b>0.00%</b>
<b>01-4-0003 SERVICE FEE</b>			
01-4-000301.00 RECORDING FEE	23,000.00	6,928.00	30.12%
01-4-000302.00 RESTORATION	0.00	0.00	0.00%
01-4-000303.00 DOCUMENT COPY FEE	2,100.00	323.00	15.38%
01-4-000305.00 USE OF RECRDS FEE	225.00	23.00	10.22%
01-4-000307.00 VITAL STATISTIC FEE	1,000.00	80.00	8.00%
01-4-000309.00 MTR VEH REG RNWL FEE	80.00	0.00	0.00%
01-4-000311.00 PHOTOCOPYING FEE	10.00	0.00	0.00%
01-4-000315.00 PASSPORT	0.00	0.00	0.00%
01-4-000317.00 EV CHARGING FEES	800.00	0.00	0.00%
01-4-000320.00 TRACY HALL RNTL FEE	7,100.00	0.00	0.00%
01-4-000325.00 POLICE RPT FEE	400.00	84.00	21.00%
01-4-000326.00 POLICE ALRM RESP FEE	150.00	0.00	0.00%
01-4-000327.00 SPECIAL POLICE DUTY FEES	0.00	0.00	0.00%
01-4-000350.00 PLNG DOC COPY FEE	0.00	0.00	0.00%
01-4-000352.00 PLANNING MAPS	0.00	0.00	0.00%
01-4-000355.00 RECREATION FEES	200,000.00	2,435.00	1.22%

Account	Budget	Actual	Actual % of Budget
01-4-000360.00 TRANSFR STATION STICKERS	28,000.00	15,116.00	53.99%
01-4-000362.00 MISC SOLID WASTE	3,500.00	337.70	9.65%
01-4-000363.00 E-WASTE	3,000.00	147.00	4.90%
01-4-000364.00 TRASH COUPON	100,000.00	15,517.00	15.52%
01-4-000365.00 RECYCLING REBATES	6,500.00	657.67	10.12%
01-4-000366.00 C & D WASTE	7,500.00	1,317.00	17.56%
<b>Total SERVICE FEE</b>	<b>303,365.00</b>	<b>42,965.37</b>	<b>11.21%</b>
<b>01-4-0004 GRANT REVENUE</b>			
01-4-000401.00 HIWAY PAVING GRANT	0.00	0.00	0.00%
01-4-000402.00 HIWAY BRIDGE GRANT	0.00	0.00	0.00%
01-4-000403.00 FEMA MITIGATION GRANT	0.00	0.00	0.00%
01-4-000403.10 USDA NRCS-DEBRIS REMOVAL	0.00	0.00	0.00%
01-4-000404.00 RC&D LOCAL ROADS GRANT	0.00	0.00	0.00%
01-4-000405.00 FEMA GRANT	0.00	0.00	0.00%
01-4-000406.00 BETTER BACK ROADS GRANT	0.00	0.00	0.00%
01-4-000407.00 VT Trans TAP Grant (Tiger	0.00	0.00	0.00%
01-4-000410.00 PLANNING GRANT	0.00	0.00	0.00%
01-4-000410.10 HISTORIC PRESERVATION GRA	0.00	0.00	0.00%
01-4-000411.00 ST OF VT-BIKE & PEDE GRAN	0.00	0.00	0.00%
01-4-000412.00 RECREATION DPT. GRANT	0.00	8,254.89	100.00%
01-4-000412.10 VT Recreation Restart Gra	0.00	0.00	0.00%
01-4-000412.20 MAHHC Grant	0.00	0.00	0.00%
01-4-000415.00 CONSERV COMM GRANT	0.00	0.00	0.00%
01-4-000416.00 CON COMM-KEEPING TRACK	0.00	0.00	0.00%
01-4-000417.00 DRY HYDRANT GRANT	0.00	0.00	0.00%
01-4-000418.00 ENERGY GRANT	0.00	0.00	0.00%
01-4-000419.00 EVCS GRANT	0.00	0.00	0.00%
01-4-000420.00 LOCAL LAW ENF GRNT	0.00	0.00	0.00%
01-4-000422.00 COPS GRANT	0.00	0.00	0.00%
01-4-000424.00 US JUSTICE DPT.VEST GRANT	0.00	0.00	0.00%
01-4-000426.00 VT COMM ENFORCEMENT GRANT	0.00	0.00	0.00%
01-4-000430.17 FY17 HOMELAND SEC #1731	0.00	0.00	0.00%
01-4-000435.17 FY17 HOMELAND SEC #1731	0.00	0.00	0.00%
01-4-000436.00 OP/DUI (GHSP)	0.00	0.00	0.00%
01-4-000437.00 HIGH RISK RURAL ROADS	0.00	0.00	0.00%
01-4-000438.00 INTEROPERABLE COMM GRANT	0.00	0.00	0.00%
01-4-000441.00 VLCT PACIF GRANT	0.00	0.00	0.00%
01-4-000442.17 2017 GOVERNORS HWY SAFETY	0.00	0.00	0.00%
01-4-000443.00 PRESERVATION TRUST-TREE	0.00	0.00	0.00%
01-4-000444.00 NORWICH WOMENS CLUB GRANT	0.00	0.00	0.00%
01-4-000444.10 NWC Grant - Police	0.00	0.00	0.00%
01-4-000444.20 NWC Grant - Recreation	0.00	0.00	0.00%
01-4-000444.30 NWC Grant - Conserv Comm	0.00	0.00	0.00%
01-4-000445.00 FIRE & EMER RECRUITMENT	0.00	0.00	0.00%
01-4-000446.00 2017 VTRANS BIKE & PED	0.00	0.00	0.00%
01-4-000447.00 2017 VTRANS BIKE & PED GR	0.00	0.00	0.00%
01-4-000460.00 SOLID WASTE GRANT	0.00	0.00	0.00%
01-4-000470.00 ENERGY COMM GRANT-NEGRASS	0.00	0.00	0.00%

Account	Budget	Actual	% of Budget
<b>Total GRANT REVENUE</b>	<b>0.00</b>	<b>8,254.89</b>	<b>100.00%</b>
<b>01-4-0008 OTHER TOWN REVENUES</b>			
01-4-000808.00 TOWN REPORT	1,350.00	0.00	0.00%
01-4-000810.00 BANK INTEREST	20,000.00	0.00	0.00%
01-4-000810.10	0.00	0.00	0.00%
01-4-000811.00 TRANSFER IN DESIG. FUND	0.00	0.00	0.00%
01-4-000812.00 TAX SALE	0.00	0.00	0.00%
01-4-000813.00 INSURANCE CLAIMS	0.00	0.00	0.00%
01-4-000814.00 FIELD RENTAL	32,000.00	0.00	0.00%
01-4-000817.00 SALE OF TOWN ASSETS	0.00	0.00	0.00%
01-4-000822.00 LINE OF CREDIT-FEMA PROCE	0.00	0.00	0.00%
01-4-000823.00 Loan Proceeds	0.00	0.00	0.00%
<b>Total OTHER TOWN REVENUES</b>	<b>53,350.00</b>	<b>0.00</b>	<b>0.00%</b>
<b>01-4-001 PUBLIC SAFETY REVENUES</b>			
01-4-001005.00 POLICE FINE	10,000.00	0.00	0.00%
01-4-001007.00 PARKING FINE	350.00	0.00	0.00%
01-4-001008.00 DOG FINE	125.00	100.00	80.00%
<b>Total PUBLIC SAFETY REVENUES</b>	<b>10,475.00</b>	<b>100.00</b>	<b>0.95%</b>
<b>01-4-009 MISCELLANEOUS REVENUE</b>			
01-4-009001.00 DAILY OVER/SHORT	0.00	0.00	0.00%
01-4-009002.00 VLCT LEADER PROGRAM	0.00	0.00	0.00%
01-4-009005.00 AMBULANCE BILLS PAID	0.00	0.00	0.00%
01-4-009007.00 DONATIONS	0.00	0.00	0.00%
01-4-009007.10 Brown Schoolhouse Bridge	0.00	0.00	0.00%
01-4-009009.00 DONATIONS-KEEPING TRACK	0.00	0.00	0.00%
01-4-009011.00 DONATIONS-HISTORIC PRESER	0.00	0.00	0.00%
01-4-009100.00 TOWN CLRK MISCEL	0.00	2.00	100.00%
01-4-009200.00 FIN DEPT MISCEL	0.00	0.00	0.00%
01-4-009300.00 LISTER DEPT MISCEL	0.00	0.00	0.00%
01-4-009350.00 PLAN DEPT MISCEL	0.00	0.00	0.00%
01-4-009425.00 RECRE DEPT MISCEL	0.00	1,050.00	100.00%
01-4-009500.00 POLICE DEPT MISC	0.00	822.65	100.00%
01-4-009555.00 FIRE DEPT. MISCEL	0.00	0.00	0.00%
01-4-009600.00 COBRA REIMBURSEMENT	0.00	0.00	0.00%
01-4-009700.00 HIWAY DEPT MISCEL	0.00	0.00	0.00%
01-4-009800.00 CONSERVATION COMM.	0.00	0.00	0.00%
01-4-009900.00 MISCELLANEOUS	500.00	3.00	0.60%
01-4-009900.01 Misc DOL Payment	0.00	0.00	0.00%
<b>Total MISCELLANEOUS REVENUE</b>	<b>500.00</b>	<b>1,877.65</b>	<b>375.53%</b>
<b>Total Revenues</b>	<b>4,994,041.00</b>	<b>16,493,243.07</b>	<b>330.26%</b>

Account	Budget	Actual	% of Budget
<b>01-5-005 TOWN ADMIN. EXPENSE</b>			
01-5-005110.00 SELECTBOARD STIPEND	2,500.00	0.00	0.00%
01-5-005111.00 TOWN MANAGER WAGE	94,010.00	13,986.44	14.88%
01-5-005111.10 TM BENEFITS	0.00	0.00	0.00%
01-5-005113.00 TREASURER STIPEND	1,750.00	0.00	0.00%
01-5-005114.00 ADMIN ASSIST WAGE	53,015.00	8,157.29	15.39%
01-5-005114.10 ADMIN ASST OT	500.00	0.00	0.00%
01-5-005121.00 FICA TAX	9,410.00	1,340.89	14.25%
01-5-005122.00 MEDI TAX	2,201.00	313.60	14.25%
01-5-005123.00 HEALTH INSUR	46,701.00	11,397.72	24.41%
01-5-005124.00 DISABILITY/LIFE INSUR	1,721.00	389.31	22.62%
01-5-005125.00 DENTAL INSURANCE	446.00	117.66	26.38%
01-5-005126.00 VT RETIREMENT	8,483.00	1,328.64	15.66%
01-5-005126.01 VT RETIREMENT ADJUSTMENT	0.00	0.00	0.00%
01-5-005250.00 TOWN MNGR RECRT	0.00	0.00	0.00%
01-5-005252.00 TMGR RELOCATION EXPENSE	0.00	0.00	0.00%
01-5-005300.00 PROFESS SERV	51,667.00	42,378.41	82.02%
01-5-005301.00 PROF SERVICES-DAM LITIGAT	0.00	0.00	0.00%
01-5-005302.00 VLCT MEMBERSHIP	5,270.00	5,328.00	101.10%
01-5-005310.00 TOWN REPORT	4,200.00	0.00	0.00%
01-5-005531.00 ADMIN TELEPHONE	625.00	39.86	6.38%
01-5-005532.00 T MNGR CELL PHONE	650.00	84.28	12.97%
01-5-005538.00 POSTAGE	100.00	0.00	0.00%
01-5-005540.00 ADVERTISING	1,500.00	91.80	6.12%
01-5-005550.00 PRINTING	100.00	0.00	0.00%
01-5-005580.00 T MNGR VEHICLE	0.00	0.00	0.00%
01-5-005581.00 MILEAGE	300.00	0.00	0.00%
01-5-005610.00 OFFICE SUPPLIES	500.00	417.65	83.53%
01-5-005611.00 OFFICE EQUIP	300.00	0.00	0.00%
01-5-005615.00 DUES/MTS/EDUC	1,800.00	0.00	0.00%
01-5-005701.00 COMMITTEE	0.00	0.00	0.00%
01-5-005701.10 ENERGY COMMITTEE GRANT	0.00	0.00	0.00%
01-5-005701.20 ENERGY COMMITTEE	1,460.00	0.00	0.00%
01-5-005701.30 EVCS GRANT	0.00	0.00	0.00%
01-5-005701.40 NEGRASS GRANT	0.00	0.00	0.00%
01-5-005703.00 GRANT MATCH	0.00	0.00	0.00%
01-5-005810.00 DES FUND-FACILITIES STUDY	0.00	0.00	0.00%
01-5-005814.00 DESI FUND-CITIZEN ASSISTA	0.00	0.00	0.00%
01-5-005900.00 MISCELLANEOUS	500.00	0.00	0.00%
01-5-005900.01 BEC Payments	0.00	0.00	0.00%
<b>Total TOWN ADMIN. EXPENSE</b>	<b>289,709.00</b>	<b>85,371.55</b>	<b>29.47%</b>
<b>01-5-010 BCA/BOA EXPENDITURES</b>			
01-5-010110.00 JUSTICES WAGE	500.00	0.00	0.00%
01-5-010121.00 FICA TAX	0.00	0.00	0.00%
01-5-010122.00 MEDI TAX	0.00	0.00	0.00%
01-5-010200.00 CONTRACTED SERVICES	0.00	0.00	0.00%
01-5-010538.00 POSTAGE	150.00	0.00	0.00%
01-5-010580.00 TRAVEL REIMB	0.00	0.00	0.00%



Account	Budget	Actual	% of Budget
01-5-010610.00 OFFICE SUPPLIES	25.00	0.00	0.00%
01-5-010615.00 DUES/MTGS/EDUC	300.00	0.00	0.00%
<b>Total BCA/BOA EXPENDITURES</b>	<b>975.00</b>	<b>0.00</b>	<b>0.00%</b>
<b>01-5-050 STAT MTGS EXPENDITURES</b>			
01-5-050110.00 POLLWORKERS WAGE	1,200.00	0.00	0.00%
01-5-050121.00 FICA TAX	0.00	0.00	0.00%
01-5-050122.00 MEDI TAX	0.00	0.00	0.00%
01-5-050200.00 CONTRACTED SERVICES	0.00	0.00	0.00%
01-5-050538.00 POSTAGE	125.00	1,183.50	946.80%
01-5-050540.00 ADVERTISING	180.00	0.00	0.00%
01-5-050550.00 PRINTING	1,900.00	0.00	0.00%
01-5-050610.00 OFFICE SUPPLIES	100.00	371.97	371.97%
01-5-050612.00 VOTING BOOTHS	0.00	0.00	0.00%
01-5-050650.00 VOTING MACHINE	70.00	0.00	0.00%
01-5-050652.00 VOTING MACH MAINT AGRMT	0.00	0.00	0.00%
01-5-050655.00 VTG MCHN PROGRAM	3,400.00	0.00	0.00%
<b>Total STAT MTGS EXPENDITURES</b>	<b>6,975.00</b>	<b>1,555.47</b>	<b>22.30%</b>
<b>01-5-100 TOWN CLERK EXPENDITURES</b>			
01-5-100110.00 TOWN CLERK WAGE	69,935.00	10,707.50	15.31%
01-5-100112.00 ASST CLK WAGE	45,270.00	8,810.66	19.46%
01-5-100121.00 FICA TAX	7,143.00	1,197.75	16.77%
01-5-100122.00 MEDI TAX	1,670.00	280.12	16.77%
01-5-100123.00 HEALTH INS	30,686.00	6,627.43	21.60%
01-5-100124.00 DISABILITY/LIFE INS	1,412.00	315.33	22.33%
01-5-100125.00 DENTAL INSURANCE	864.00	181.58	21.02%
01-5-100126.00 VT RETIREMENT	6,624.00	1,171.10	17.68%
01-5-100207.00 DOG/CAT LICENSE	300.00	0.00	0.00%
01-5-100209.00 VITAL STATISTICS	15.00	0.00	0.00%
01-5-100325.00 CONTRACT LABOR	0.00	852.14	100.00%
01-5-100341.00 RECORD RESTORATION	0.00	540.75	100.00%
01-5-100342.00 Permit/license refund	0.00	0.00	0.00%
01-5-100531.00 TELEPHONE	515.00	39.84	7.74%
01-5-100538.00 POSTAGE	0.00	0.00	0.00%
01-5-100540.00 ADVERTISING	0.00	0.00	0.00%
01-5-100550.00 PRINTING	0.00	0.00	0.00%
01-5-100610.00 OFFICE SUPPLIES	1,500.00	705.00	47.00%
01-5-100611.00 OFFICE EQUIPMENT	500.00	0.00	0.00%
01-5-100613.00 SOFTWARE	3,720.00	520.00	13.98%
01-5-100615.00 DUES/MTGS/EDUC	255.00	0.00	0.00%
01-5-100617.00 WOMEN'S CLUB GRANT	0.00	0.00	0.00%
01-5-100758.00 DES. FUND-RECORD RESTORAT	5,000.00	0.00	0.00%
01-5-100760.00 DESIGNATED FUND- EQUIP	0.00	0.00	0.00%
<b>Total TOWN CLERK EXPENDITURES</b>	<b>175,409.00</b>	<b>31,949.20</b>	<b>18.21%</b>
<b>01-5-200 FINANCE DEPARTMENT</b>			

Account	Budget	Actual	% of Budget
01-5-200112.00 FINL ASSISTANT WAGE	22,186.00	16,055.17	72.37%
01-5-200112.10 FINANCE OFFICER WAGE	65,870.00	1,641.50	2.49%
01-5-200121.00 FICA TAX	5,459.00	13.42	0.25%
01-5-200122.00 MEDI TAX	1,277.00	3.14	0.25%
01-5-200123.00 HEALTH INS	23,350.00	0.00	0.00%
01-5-200124.00 DISABILITY/LIFE INS	860.00	0.00	0.00%
01-5-200125.00 DENTAL INSURANCE	446.00	0.00	0.00%
01-5-200126.00 VT RETIREMENT	3,788.00	0.00	0.00%
01-5-200130.00 CONTRACT LABOR	0.00	0.00	0.00%
01-5-200320.00 PROFESS SERVICES	0.00	0.00	0.00%
01-5-200322.00 INDEPENDENT AUDIT	15,500.00	0.00	0.00%
01-5-200531.00 TELEPHONE	500.00	68.41	13.68%
01-5-200538.00 POSTAGE	0.00	0.00	0.00%
01-5-200540.00 ADVERTISING	200.00	0.00	0.00%
01-5-200550.00 PRINTING	75.00	0.00	0.00%
01-5-200580.00 MILEAGE REIMBURSEMENT	0.00	0.00	0.00%
01-5-200610.00 OFFICE SUPPLIES	1,500.00	281.69	18.78%
01-5-200611.00 OFFICE EQUIPMENT	250.00	0.00	0.00%
01-5-200613.00 SOFTWARE	1,275.00	0.00	0.00%
01-5-200615.00 DUES/MTGS/EDUC	1,000.00	0.00	0.00%
01-5-200711.00 BANK	0.00	0.00	0.00%
<b>Total FINANCE DEPARTMENT</b>	<b>143,536.00</b>	<b>18,063.33</b>	<b>12.58%</b>
<b>01-5-275 GEN ADMIN EXPENDITURES</b>			
01-5-275531.00 TELEPHONE	800.00	137.83	17.23%
01-5-275536.00 POSTAGE METER RENTAL	700.00	0.00	0.00%
01-5-275538.00 POSTAGE	3,500.00	5,025.82	143.59%
01-5-275610.00 OFFICE SUPPLIES	1,000.00	244.86	24.49%
01-5-275620.00 PHOTOCOPIER	2,500.00	0.00	0.00%
01-5-275628.00 COMPUTER SOFTWARE	0.00	0.00	0.00%
01-5-275630.00 COMPUTER HARDWARE	0.00	0.00	0.00%
01-5-275631.00 WEB SITE SUPPORT	500.00	0.00	0.00%
01-5-275632.00 SERVER MAINTENANCE	7,000.00	49.87	0.71%
01-5-275760.00 DESIGNATED FUND-EQUIP	5,500.00	0.00	0.00%
<b>Total GEN ADMIN EXPENDITURES</b>	<b>21,500.00</b>	<b>5,458.38</b>	<b>25.39%</b>
<b>01-5-300 LISTER/ASSESSOR EXPENDITURE</b>			
01-5-300110.00 LISTER WAGE	4,500.00	0.00	0.00%
01-5-300112.00 OFFICE ASST WAGE	17,700.00	2,880.95	16.28%
01-5-300114.00 ASSESSOR WAGE	0.00	0.00	0.00%
01-5-300121.00 FICA TAX	1,376.00	178.62	12.98%
01-5-300122.00 MEDI TAX	322.00	41.77	12.97%
01-5-300123.00 HEALTH INS	0.00	0.00	0.00%
01-5-300124.00 DISABILITY/LIFE INSURANCE	0.00	0.00	0.00%
01-5-300125.00 DENTAL INSURANCE	0.00	0.00	0.00%
01-5-300126.00 VT RETIREMENT	0.00	0.00	0.00%
01-5-300300.00 PROFESS SERVICES	45,000.00	3,006.90	6.68%
01-5-300320.00 LEGAL SERVICES	0.00	0.00	0.00%

Account	Budget	Actual	% of Budget
01-5-300341.00 TAX MAPPING	0.00	0.00	0.00%
01-5-300360.00 SOFTWARE MAINT/UPDATE	6,500.00	0.00	0.00%
01-5-300531.00 TELEPHONE	530.00	39.84	7.52%
01-5-300538.00 POSTAGE	600.00	14.17	2.36%
01-5-300540.00 ADVERTISING	150.00	0.00	0.00%
01-5-300550.00 PRINTING	100.00	25.50	25.50%
01-5-300580.00 MILEAGE REIMB	150.00	0.00	0.00%
01-5-300610.00 OFFICE SUPPLIES	125.00	0.00	0.00%
01-5-300611.00 OFFICE EQUIPMENT	150.00	0.00	0.00%
01-5-300615.00 DUES/MTGS/EDUC	100.00	0.00	0.00%
01-5-300760.00 DESIGNATED FUND-REAPPR	33,800.00	0.00	0.00%
<b>Total LISTER/ASSESSOR EXPENDITURE</b>	<b>111,103.00</b>	<b>6,167.75</b>	<b>5.57%</b>
<b>01-5-350 PLANNING DEPT EXPENDITURE</b>			
01-5-350110.00 PLAN ADMIN WAGE	72,726.00	10,818.70	14.88%
01-5-350112.00 OFFICE ASST. WAGE	24,985.00	3,930.10	15.73%
01-5-350121.00 FICA TAX	6,058.00	883.59	14.59%
01-5-350122.00 MEDI TAX	1,417.00	206.65	14.58%
01-5-350123.00 HEALTH INS	15,024.00	4,665.60	31.05%
01-5-350124.00 DISABILITY/LIFE INS	878.00	202.86	23.10%
01-5-350125.00 DENTAL INSURANCE	446.00	74.38	16.68%
01-5-350126.00 VT RETIREMENT	4,182.00	649.13	15.52%
01-5-350130.00 CONTRACT LABOR	0.00	0.00	0.00%
01-5-350230.00 TOWN PLAN	1,000.00	0.00	0.00%
01-5-350320.00 PLANNING SERVICES	3,000.00	0.00	0.00%
01-5-350321.00 TWO RIVER PLANNING COMM.	5,223.00	5,223.00	100.00%
01-5-350322.00 U.V. TRANSPORTATION MGMT	1,063.00	0.00	0.00%
01-5-350341.00 MAPPING	2,000.00	0.00	0.00%
01-5-350405.14 2014 ST OF VT PLAN GRANT	0.00	0.00	0.00%
01-5-350406.00 BIKE/PED TECHNICAL GRANT	0.00	0.00	0.00%
01-5-350408.00 HISTORIC PRES COMM.	750.00	0.00	0.00%
01-5-350416.00 HIST PRES GRANT	0.00	0.00	0.00%
01-5-350418.00 WOMEN'S CLUB GRANT	0.00	0.00	0.00%
01-5-350419.00 PLANNING GRANT	6,000.00	0.00	0.00%
01-5-350531.00 TELEPHONE	450.00	39.84	8.85%
01-5-350538.00 POSTAGE	350.00	0.00	0.00%
01-5-350540.00 ADVERTISING	500.00	0.00	0.00%
01-5-350550.00 PRINTING	200.00	0.00	0.00%
01-5-350580.00 MILEAGE REIMB	400.00	0.00	0.00%
01-5-350610.00 OFFICE SUPPLIES	400.00	0.00	0.00%
01-5-350611.00 OFFICE EQUIPMENT	250.00	0.00	0.00%
01-5-350615.00 DUES/MTGS/EDUC	750.00	0.00	0.00%
<b>Total PLANNING DEPT EXPENDITURE</b>	<b>148,052.00</b>	<b>26,693.85</b>	<b>18.03%</b>
<b>01-5-425 RECREA DEPT EXPENDITURES</b>			
<b>01-5-4251 ADMINISTRATION</b>			
01-5-425110.00 RECREATION DIR WAGE	67,187.00	10,337.52	15.39%
01-5-425113.00 RECREATION ASSISTANT	0.00	0.00	0.00%

Account	Budget	Actual	% of Budget
01-5-425115.00 EV Chg @ Huntley Meadow	0.00	0.00	0.00%
01-5-425121.00 FICA TAX	4,166.00	1,330.91	31.95%
01-5-425122.00 MEDI TAX	974.00	311.31	31.96%
01-5-425123.00 HEALTH INS	23,350.00	6,712.86	28.75%
01-5-425124.00 DISABILITY/LIFE INSUR	862.00	193.74	22.48%
01-5-425125.00 DENTAL INSURANCE	446.00	117.66	26.38%
01-5-425126.00 VT RETIREMENT	3,863.00	620.25	16.06%
01-5-425127.00 TELEPHONE	500.00	39.84	7.97%
01-5-425128.00 POSTAGE	150.00	0.00	0.00%
01-5-425130.00 WOMENS CLUB GRANT	0.00	0.00	0.00%
01-5-425140.00 ADVERTISING	135.00	0.00	0.00%
01-5-425150.00 PRINTING	50.00	0.00	0.00%
01-5-425160.00 DUES/MTGS/EDUC	800.00	0.00	0.00%
01-5-425170.00 OFFICE EQUIPMENT	50.00	0.00	0.00%
01-5-425180.00 MILEAGE REIMBURSEMENT	300.00	0.00	0.00%
01-5-425182.00 OFFICE SUPPLIES	225.00	0.00	0.00%
<b>Total ADMINISTRATION</b>	<b>103,088.00</b>	<b>19,664.09</b>	<b>19.08%</b>
<b>01-5-4252 PROGRAM</b>			
01-5-425200.00 INSTRUCTOR FEE	65,000.00	735.00	1.13%
01-5-425206.00 COACHING MATERIALS	450.00	0.00	0.00%
01-5-425208.00 TEE SHIRT/HAT	3,000.00	0.00	0.00%
01-5-425211.00 EQUIPMENT	3,500.00	470.19	13.43%
01-5-425212.00 PROGRAM WAGE	38,000.00	31,370.35	82.55%
01-5-425214.00 REFERREE/UMPIRE	3,600.00	0.00	0.00%
01-5-425216.00 ENTRY FEE	4,500.00	0.00	0.00%
01-5-425218.00 REGISTRATION FEES	8,500.00	0.00	0.00%
01-5-425219.00 M.CROSS SCHOOL RENTAL FEE	0.00	0.00	0.00%
01-5-425220.00 SPECIAL EVENTS /SUPPLIES	1,500.00	99.75	6.65%
01-5-425221.00 FICA TAX	2,356.00	1,190.92	50.55%
01-5-425222.00 MEDI TAX	551.00	278.58	50.56%
01-5-425224.00 UV RAPIDS	0.00	0.00	0.00%
01-5-425244.00 UNIFORMS	700.00	0.00	0.00%
01-5-425248.00 MIDDLE SCHOOL RECREATION	0.00	0.00	0.00%
<b>Total PROGRAM</b>	<b>131,657.00</b>	<b>34,144.79</b>	<b>25.93%</b>
<b>01-5-4253 RECREATION FACILITIES</b>			
01-5-425322.00 REC FIELD CARE	7,500.00	0.00	0.00%
01-5-425324.00 HNTLY LINE MARKING	3,500.00	0.00	0.00%
01-5-425326.00 PORTABLE TOILET	1,200.00	285.00	23.75%
01-5-425330.00 REPAIRS & MAINT	2,500.00	0.00	0.00%
01-5-425332.00 WATER USAGE	420.00	0.00	0.00%
01-5-425333.00 WOMEN'S CLUB GRANT	2,500.00	0.00	0.00%
01-5-425345.00 SITE WORK	0.00	0.00	0.00%
01-5-425346.00 NORWICH POOL	0.00	0.00	0.00%
01-5-425347.00 FEMA-POOL GRANT	0.00	0.00	0.00%
01-5-425350.00 MAHHC Prevention Grant	0.00	814.53	100.00%
01-5-425350.10 VT Recreation Restart Gra	0.00	1,641.95	100.00%

Account	Budget	Actual	% of Budget
01-5-425360.00 DESIGNATED FUND-T COURTS	4,500.00	0.00	0.00%
01-5-425361.00 DESIGNATED FUND-DAM	0.00	0.00	0.00%
<b>Total RECREATION FACILITIES</b>	<b>22,120.00</b>	<b>2,741.48</b>	<b>12.39%</b>
<b>Total RECREA DEPT EXPENDITURES</b>	<b>256,835.00</b>	<b>56,850.36</b>	<b>22.02%</b>
<b>01-5-485 PUBLIC SAFETY FACILITY</b>			
01-5-485232.00 WATER USAGE	1,000.00	0.00	0.00%
01-5-485233.00 ELECTRICITY	6,250.00	1,062.00	16.99%
01-5-485234.00 HEATING	3,000.00	0.00	0.00%
01-5-485234.10 Apparatus Bay FD	0.00	0.00	0.00%
01-5-485238.00 PHONE & INTERNET	4,500.00	868.93	19.31%
01-5-485301.00 BUILDING SUPPLIES	1,000.00	26.68	2.67%
01-5-485302.00 REPAIRS & MAINTENANCE	1,750.00	31.96	1.83%
01-5-485302.10 Apparatus (NFD)	0.00	0.00	0.00%
01-5-485303.00 ALARM MONITORING	210.00	215.29	102.52%
01-5-485304.00 CLEANING	11,000.00	1,260.00	11.45%
01-5-485760.00 DESIGNATED FUND-POLICE ST	3,500.00	0.00	0.00%
<b>Total PUBLIC SAFETY FACILITY</b>	<b>32,210.00</b>	<b>3,464.86</b>	<b>10.76%</b>
<b>01-5-500 POLICE DEPT EXPENDITURES</b>			
<b>01-5-5001 WAGES &amp; BENEFITS</b>			
01-5-500110.00 POLICE CHIEF WAGE	84,093.00	13,489.63	16.04%
01-5-500110.10 INT. CHIEF THETFORD	0.00	0.00	0.00%
01-5-500112.00 POLICE OFFICER WAGE	168,822.00	22,699.32	13.45%
01-5-500112.10 ON-CALL WAGES	7,000.00	710.22	10.15%
01-5-500113.00 OVERTIME OFFICER WAGE	23,843.00	1,696.58	7.12%
01-5-500114.00 ADMINISTRATIVE WAGE	49,412.00	7,324.00	14.82%
01-5-500115.00 PARTTIME OFFICER WAGE	5,000.00	0.00	0.00%
01-5-500116.00 CROSSING GUARD WAGE	15,200.00	0.00	0.00%
01-5-500117.00 GOVERNOR'S HWY SAFETY GRA	0.00	4,639.62	100.00%
01-5-500118.00 SPECIAL DUTY WAGE	250.00	0.00	0.00%
01-5-500120.00 FEMA	0.00	0.00	0.00%
01-5-500121.00 FICA TAX	21,924.00	2,834.23	12.93%
01-5-500122.00 MEDI TAX	5,127.00	662.85	12.93%
01-5-500123.00 HEALTH INS	68,437.00	16,785.86	24.53%
01-5-500124.00 DISABILITY/LIFE INS	3,708.00	637.77	17.20%
01-5-500125.00 DELTA DENTAL	2,160.00	404.72	18.74%
01-5-500126.00 VT RETIREMENT	24,350.00	3,464.63	14.23%
<b>Total WAGES &amp; BENEFITS</b>	<b>479,326.00</b>	<b>75,349.43</b>	<b>15.72%</b>
<b>01-5-5002 COMMUNITY POLICING</b>			
01-5-500201.00 ANIMAL CONT/LEASH LAW	2,500.00	0.00	0.00%
01-5-500201.10 Dog fine refund	0.00	0.00	0.00%
01-5-500202.00 COMMUNITY RELATNS	1,200.00	63.59	5.30%
01-5-500204.00 SPEED SIGNS	1,800.00	288.00	16.00%

Account	Budget	Actual	% of Budget
01-5-500206.00 NORWIIICH CADET PROGRAM	500.00	0.00	0.00%
<b>Total COMMUNITY POLICING</b>	<b>6,000.00</b>	<b>351.59</b>	<b>5.86%</b>
<b>01-5-5003 EQUIPMENT &amp; MAINTENANCE</b>			
01-5-500301.00 RADIO MAINTENANCE	800.00	0.00	0.00%
01-5-500302.00 PETROLEUM PRODUCTS	8,000.00	0.00	0.00%
01-5-500304.00 CRUISER VIDEO EQUIP	500.00	0.00	0.00%
01-5-500306.00 CRUISER MAINT	10,200.00	82.62	0.81%
01-5-500308.00 CRUISER SUPPLIES	500.00	0.00	0.00%
<b>Total EQUIPMENT &amp; MAINTENANCE</b>	<b>20,000.00</b>	<b>82.62</b>	<b>0.41%</b>
<b>01-5-5004 GRANTS</b>			
01-5-500423.13 EQUIPMENT INCENTIVE GRANT	0.00	0.00	0.00%
01-5-500423.14 2014 EQUIPMENT INCENTIVES	0.00	0.00	0.00%
01-5-500423.15 2015 EQUIP INCENTIVE GRAN	0.00	0.00	0.00%
01-5-500423.17 FY17 OP/DUI EQUIPMENT GRA	0.00	0.00	0.00%
01-5-500428.00 PACIF EQUIP GRANT	0.00	0.00	0.00%
01-5-500430.00 DOJ BULLET PROOF VESTS GR	0.00	0.00	0.00%
01-5-500432.00 NORWICH WOMENS CLUB GRANT	0.00	0.00	0.00%
01-5-500436.00 2015 DUI ENFORCEMENT GRAN	0.00	0.00	0.00%
<b>Total GRANTS</b>	<b>0.00</b>	<b>0.00</b>	<b>0.00%</b>
<b>01-5-5005 SUPPORT</b>			
01-5-500501.00 ADMINISTRATION	4,000.00	758.05	18.95%
01-5-500535.00 VIBRS	3,000.00	115.31	3.84%
01-5-500536.00 DISPATCH SERVICES	67,292.00	16,822.75	25.00%
01-5-500538.00 TRAINING	2,500.00	0.00	0.00%
01-5-500543.00 TRAINING SUPPLIES	2,000.00	0.00	0.00%
01-5-500580.00 MILEAGE REIMB	200.00	0.00	0.00%
01-5-500581.00 DUES/MTGS/EDUC	1,000.00	375.00	37.50%
01-5-500582.00 UNIFORMS	2,500.00	346.94	13.88%
01-5-500583.00 UNIFORMS CLEANING	1,500.00	159.75	10.65%
01-5-500584.00 BULLET PROOF VESTS	0.00	0.00	0.00%
<b>Total SUPPORT</b>	<b>83,992.00</b>	<b>18,577.80</b>	<b>22.12%</b>
<b>01-5-5007 CAPITAL EXPENDITURES</b>			
01-5-500701.00 DESIGNATED FUND-SPEC EQUI	2,500.00	0.00	0.00%
01-5-500702.00 DESIGNATED FUND-CRUISER	20,000.00	0.00	0.00%
01-5-500703.00 DESIGNATED FUND-POLICE ST	0.00	0.00	0.00%
<b>Total CAPITAL EXPENDITURES</b>	<b>22,500.00</b>	<b>0.00</b>	<b>0.00%</b>
<b>Total POLICE DEPT EXPENDITURES</b>	<b>611,818.00</b>	<b>94,361.44</b>	<b>15.42%</b>
<b>01-5-555 FIRE/FAST DEPT. EXPENSES</b>			
<b>01-5-5551 FIRE WAGES</b>			

Account	Budget	Actual	% of Budget
01-5-555108.00 FIRE CHIEF WAGES	65,185.00	10,557.49	16.20%
01-5-555110.00 FIRE OFFICER STIPEND	2,100.00	0.00	0.00%
01-5-555112.00 FIREFIGHTERS WAGE	34,000.00	7,457.62	21.93%
01-5-555114.00 FF DRILLS/MTGS WAGE	3,000.00	400.00	13.33%
01-5-555116.00 DRY HYDRANT WAGE	0.00	0.00	0.00%
01-5-555121.00 FICA TAX	6,466.00	1,095.70	16.95%
01-5-555122.00 MEDI TAX	1,512.00	256.25	16.95%
01-5-555123.00 HEALTH INSURANCE	16,276.00	4,752.15	29.20%
01-5-555124.00 DISABILITY/LIFE INSURANCE	817.00	188.43	23.06%
01-5-555125.00 VT RETIREMENT	3,748.00	633.44	16.90%
01-5-555126.00 DENTAL INSURANCE	446.00	78.91	17.69%
<b>Total FIRE WAGES</b>	<b>133,550.00</b>	<b>28,419.99</b>	<b>19.03%</b>
<b>01-5-5552 EMS WAGES</b>			
01-5-555212.00 EMS WAGE	5,500.00	891.86	16.22%
01-5-555215.00 EMS DRILL WAGE	1,900.00	180.00	9.47%
01-5-555221.00 EMS FICA TAX	459.00	65.25	14.22%
01-5-555222.00 EMS MEDI TAX	107.00	15.24	14.24%
<b>Total EMS WAGES</b>	<b>7,966.00</b>	<b>1,152.35</b>	<b>14.47%</b>
<b>01-5-5553 EDUCATION &amp; TRAINING</b>			
01-5-555338.00 FIRE EDUC/TRAINING	750.00	0.00	0.00%
01-5-555340.00 EMS EDUC/TRNG	1,200.00	0.00	0.00%
01-5-555342.00 FIRE DUES/MTGS/EDUC	750.00	0.00	0.00%
01-5-555343.00 EMS DUES/MTGS	0.00	0.00	0.00%
<b>Total EDUCATION &amp; TRAINING</b>	<b>2,700.00</b>	<b>0.00</b>	<b>0.00%</b>
<b>01-5-5554 TOOLS &amp; EQUIPMENT</b>			
01-5-555422.00 FIRE TOOLS & EQUIPMENT	4,000.00	838.34	20.96%
01-5-555424.00 EMS TOOLS/ EQUIP	1,900.00	23.75	1.25%
01-5-555426.00 RADIO PURCH/REPAIR	750.00	0.00	0.00%
<b>Total TOOLS &amp; EQUIPMENT</b>	<b>6,650.00</b>	<b>862.09</b>	<b>12.96%</b>
<b>01-5-5555 MAINTENANCE</b>			
01-5-555528.00 FIRE TRK R & M	14,000.00	824.98	5.89%
01-5-555530.00 EQUIPMENT MAINTENANCE	5,800.00	0.00	0.00%
01-5-555532.00 RADIO MAINTENANCE	500.00	0.00	0.00%
01-5-555534.00 SOFTWARE MAINTENANCE	400.00	0.00	0.00%
01-5-555536.00 COMPUTER MAINTENANCE	400.00	0.00	0.00%
01-5-555538.00 PETROLEUM PRODUCTS	3,000.00	0.00	0.00%
<b>Total MAINTENANCE</b>	<b>24,100.00</b>	<b>824.98</b>	<b>3.42%</b>
<b>01-5-5556 SUPPORT</b>			
01-5-555614.00 RECRUITMENT	100.00	0.00	0.00%
01-5-555616.00 VEHICLE ALLOWANCE	0.00	0.00	0.00%

Account	Budget	Actual	% of Budget
01-5-555617.00 FIRETRUCK STORAGE	0.00	0.00	0.00%
01-5-555618.00 POSTAGE	25.00	83.40	333.60%
01-5-555619.00 FIRE PREV BOOKS & MATERIA	100.00	0.00	0.00%
01-5-555620.00 FIREFIGHTERS CASUL INS	5,200.00	0.00	0.00%
01-5-555625.00 TELEPHONE & INTERNET	0.00	80.02	100.00%
01-5-555630.00 OFFICE SUPPLIES	400.00	6.99	1.75%
01-5-555632.00 DISPATCH SERVICE	21,824.00	324.00	1.48%
01-5-555633.00 UNIFORM	225.00	143.00	63.56%
01-5-555634.00 HYDRANT RENTAL	23,000.00	0.00	0.00%
01-5-555635.00 DRY HYDRANT	200.00	0.00	0.00%
01-5-555636.00 OSHA COMPLIANCE	1,200.00	0.00	0.00%
<b>Total SUPPORT</b>	<b>52,274.00</b>	<b>637.41</b>	<b>1.22%</b>
<b>01-5-5557 CAPITAL EXPENDITURES</b>			
01-5-555756.00 DESIGNATED FUND-FIRE STAT	0.00	0.00	0.00%
01-5-555758.00 DESIGNATED FUND-APPARATUS	15,000.00	0.00	0.00%
01-5-555760.00 DESIGNATED FUND-EQUIPMENT	0.00	0.00	0.00%
<b>Total CAPITAL EXPENDITURES</b>	<b>15,000.00</b>	<b>0.00</b>	<b>0.00%</b>
<b>01-5-5558 GRANT EXPENSE</b>			
01-5-555824.00 VLCTPACIF GRANT	0.00	0.00	0.00%
01-5-555830.00 DRY HYDRANT GRANT	0.00	0.00	0.00%
01-5-555852.00 FY17 HOMELAND SEC #1731	0.00	0.00	0.00%
<b>Total GRANT EXPENSE</b>	<b>0.00</b>	<b>0.00</b>	<b>0.00%</b>
<b>01-5-5559 AMBULANCE SERVICES</b>			
01-5-555901.00 AMBULANCE CONTRACT	135,500.00	0.00	0.00%
01-5-555903.00 AMBULANCE BILLS	14,500.00	0.00	0.00%
<b>Total AMBULANCE SERVICES</b>	<b>150,000.00</b>	<b>0.00</b>	<b>0.00%</b>
<b>Total FIRE/FAST DEPT. EXPENSES</b>	<b>392,240.00</b>	<b>28,896.82</b>	<b>7.37%</b>
<b>01-5-575 EMERGENCY MANAGEMENT</b>			
01-5-575100.00 DEBT SERVICE TOWER PRINCI	30,738.00	0.00	0.00%
01-5-575105.00 DEBT SERVICE TOWER INTERE	0.00	0.00	0.00%
01-5-575233.00 TOWER POWER	600.00	0.32	0.05%
01-5-575600.00 EMERG MAN ADMIN	100.00	0.00	0.00%
01-5-575610.00 EMERG MNGMT SUPPLIES	50.00	0.00	0.00%
01-5-575612.00 GENERATOR FUEL	300.00	0.00	0.00%
01-5-575620.00 EMERG GEN MAINT	6,200.00	82.01	1.32%
01-5-575622.00 EMERG GEN INSTALL	0.00	0.00	0.00%
01-5-575628.00 PUBLIC WORKS GENERATOR	0.00	0.00	0.00%
01-5-575630.00 BASE RADIO MAINTENANCE	500.00	0.00	0.00%
01-5-575650.00 EMERG GENERATOR REPAIR	0.00	0.00	0.00%
01-5-575740.00 DESIGNATED FUND-GENERATOR	25,000.00	0.00	0.00%
01-5-575760.00 DESIGNATED FUND- COMMUNIC	0.00	0.00	0.00%



Account	Budget	Actual	% of Budget
01-5-575800.00 Haz Mitigation Plan (FEM	0.00	0.00	0.00%
<b>Total EMERGENCY MANAGEMENT</b>	<b>63,488.00</b>	<b>82.33</b>	<b>0.13%</b>
<b>01-5-650 CONSERVATION</b>			
01-5-650538.00 POSTAGE	0.00	0.00	0.00%
01-5-650550.00 PRINTING	0.00	0.00	0.00%
01-5-650605.00 DONATIONS	0.00	0.00	0.00%
01-5-650610.00 OFF SUPP & EMAIL	0.00	0.00	0.00%
01-5-650615.00 DUES/MTGS/EDUC	300.00	0.00	0.00%
01-5-650620.00 SPKRS/PUBLIC INFO	1,500.00	0.00	0.00%
01-5-650625.00 PUBLICITY	1,500.00	500.00	33.33%
01-5-650630.00 TRAILS	5,500.00	0.00	0.00%
01-5-650632.00 WATER QUAL MONIT	0.00	0.00	0.00%
01-5-650635.00 MILT FRYE NATURE AREA	1,150.00	0.00	0.00%
01-5-650640.00 GILE MT	0.00	0.00	0.00%
01-5-650700.00 NATRL RESRCS INVEN	0.00	0.00	0.00%
01-5-650710.00 PROJECT RESTORATION	1,000.00	0.00	0.00%
01-5-650725.00 GRANT	0.00	0.00	0.00%
01-5-650727.00 WOMENS CLUB GRANT	0.00	0.00	0.00%
<b>Total CONSERVATION</b>	<b>10,950.00</b>	<b>500.00</b>	<b>4.57%</b>
<b>01-5-675 CEMETERY COMMISSION</b>			
01-5-675110.00 CEMETERY WAGES	0.00	0.00	0.00%
01-5-675121.00 FICA	0.00	0.00	0.00%
01-5-675122.00 MEDI	0.00	0.00	0.00%
01-5-675126.00 RETIREMENT	0.00	0.00	0.00%
01-5-675232.00 WATER	0.00	0.00	0.00%
01-5-675301.00 SUPPLIES	0.00	0.00	0.00%
01-5-675430.00 REPAIRS & MAINT.	0.00	0.00	0.00%
01-5-675500.00 PURCHASED SERVICE	0.00	8,333.30	100.00%
01-5-675520.00 WORKERS' COMPENSATION	0.00	0.00	0.00%
01-5-675522.00 VLCT LIABILITY INSURANCE	0.00	0.00	0.00%
01-5-675538.00 POSTAGE	0.00	0.00	0.00%
01-5-675611.00 EQUIPMENT PURCHASE	0.00	0.00	0.00%
01-5-675612.00 CAPITAL IMPROVEMENTS	0.00	0.00	0.00%
01-5-675614.00 EQUIPMENT RENTAL	0.00	0.00	0.00%
01-5-675700.00 STONE CLEANING	0.00	0.00	0.00%
<b>Total CEMETERY COMMISSION</b>	<b>0.00</b>	<b>8,333.30</b>	<b>100.00%</b>
<b>01-5-70 PUBLIC WORKS DEPT.</b>			
<b>01-5-703 HIGHWAY DIVISION</b>			
<b>01-5-7031 HIGHWAY WAGES &amp; BENEFITS</b>			
01-5-703110.00 DIRECTOR OF PUBLIC WORKS	83,498.00	12,595.06	15.08%
01-5-703111.00 ADMINISTRATIVE ASSIST	20,103.00	0.00	0.00%
01-5-703112.00 ROAD CREW WAGES	325,447.00	40,927.01	12.58%
01-5-703114.00 ROAD CREW OVERTIME	29,000.00	732.86	2.53%
01-5-703116.00 PAGER COMPENSATION	3,300.00	0.00	0.00%

Account	Budget	Actual	% of Budget
01-5-703121.00 FICA	35,293.00	3,197.50	9.06%
01-5-703122.00 MEDICARE	0.00	747.83	100.00%
01-5-703123.00 HEALTH INSUR	92,030.00	21,950.38	23.85%
01-5-703124.00 DISABILITY/LIFE	5,141.00	991.62	19.29%
01-5-703125.00 DENTAL INSURANCE	2,678.00	495.51	18.50%
01-5-703126.00 RETIREMENT	25,372.00	3,255.25	12.83%
<b>Total HIGHWAY WAGES &amp; BENEFITS</b>	<b>621,862.00</b>	<b>84,893.02</b>	<b>13.65%</b>
<b>01-5-7032 MATERIALS</b>			
01-5-703201.00 SALT & CHEMICALS	120,000.00	0.00	0.00%
01-5-703203.00 SAND	100,000.00	0.00	0.00%
01-5-703205.00 DUST CONTROL	20,000.00	0.00	0.00%
01-5-703207.00 GRAVEL & STONE	50,000.00	1,907.36	3.81%
01-5-703209.00 CULVERTS & ROAD SUPPLIES	5,000.00	0.00	0.00%
01-5-703211.00 ASPHALT PRODUCTS	5,000.00	50.07	1.00%
01-5-703213.00 BRIDGE REPAIR & MAINT.	5,000.00	0.00	0.00%
01-5-703213.10 Brown Schoolhouse bridge	75,700.00	20,086.28	26.53%
01-5-703215.00 OTHER PROJECTS	2,000.00	0.00	0.00%
01-5-703217.00 SIGNS	4,000.00	0.00	0.00%
<b>Total MATERIALS</b>	<b>386,700.00</b>	<b>22,043.71</b>	<b>5.70%</b>
<b>01-5-7033 CONTRACTED SERVICES</b>			
01-5-703301.00 PLOWING & SANDING	24,000.00	0.00	0.00%
01-5-703303.00 ROAD SWEEPING	4,500.00	0.00	0.00%
01-5-703305.00 LEAF REMOVAL	6,000.00	0.00	0.00%
01-5-703307.00 STREETLIGHTS	12,000.00	1,069.95	8.92%
01-5-703309.00 TREE CUTTING & REMOVAL	12,500.00	0.00	0.00%
01-5-703311.00 UNIFORMS	10,000.00	1,264.50	12.65%
01-5-703313.00 PAVING	30,000.00	54.40	0.18%
01-5-703315.00 OTHER PROJECTS	7,500.00	0.00	0.00%
01-5-703317.00 CRACK SEALING	15,000.00	0.00	0.00%
01-5-703319.00 PAVEMENT MARKING	22,000.00	0.00	0.00%
01-5-703321.00 BRIDGES	10,000.00	0.00	0.00%
<b>Total CONTRACTED SERVICES</b>	<b>153,500.00</b>	<b>2,388.85</b>	<b>1.56%</b>
<b>01-5-7034 EQUIPMENT</b>			
01-5-703401.00 OUTSIDE REPAIRS	45,000.00	75.00	0.17%
01-5-703403.00 PARTS & SUPPLIES	45,000.00	357.50	0.79%
01-5-703405.00 PETROLEUM PRODUCTS	43,000.00	3,027.49	7.04%
<b>Total EQUIPMENT</b>	<b>133,000.00</b>	<b>3,459.99</b>	<b>2.60%</b>
<b>01-5-7035 HIGHWAY GARAGE</b>			
01-5-703501.00 ELECTRICITY	3,600.00	253.05	7.03%
01-5-703503.00 PROPANE	7,000.00	0.00	0.00%
01-5-703505.00 TELEPHONE	4,000.00	465.40	11.64%
01-5-703507.00 SUPPLIES	3,000.00	741.70	24.72%

Account	Budget	Actual	% of Budget
01-5-703509.00 ALARM MONITORING	500.00	0.00	0.00%
01-5-703511.00 REPAIRS & MAINTENANCE	9,000.00	658.00	7.31%
01-5-703513.00 TOOLS	5,000.00	188.74	3.77%
01-5-703515.00 ADMINISTRATION	5,000.00	1,196.00	23.92%
<b>Total HIGHWAY GARAGE</b>	<b>37,100.00</b>	<b>3,502.89</b>	<b>9.44%</b>
<b>01-5-7036 CAPITAL EXPENDITURES</b>			
01-5-703601.00 DESIGNATED FUND-EQUIPMENT	20,000.00	0.00	0.00%
01-5-703603.00 DESIGNATED FUND-SIDEWALK	0.00	0.00	0.00%
01-5-703605.00 DESIGNATED FUND-PAVING	60,000.00	0.00	0.00%
01-5-703607.00 DESIGNATED FUND-BRIDGES	40,000.00	0.00	0.00%
01-5-703609.00 DESIGNATED FUND-GARAGE	25,000.00	0.00	0.00%
<b>Total CAPITAL EXPENDITURES</b>	<b>145,000.00</b>	<b>0.00</b>	<b>0.00%</b>
<b>01-5-7037 GRANTS</b>			
01-5-703701.00 PAVING GRANT	0.00	0.00	0.00%
01-5-703703.00 FEMA GRANT	0.00	0.00	0.00%
01-5-703705.00 VT PUBLIC SFTY-RADIO GRAN	0.00	0.00	0.00%
01-5-703707.00 NRCS GRANT	0.00	0.00	0.00%
01-5-703709.00 TWO RIVERS-BETR BACK ROAD	5,705.00	0.00	0.00%
01-5-703710.00 ST. OF VT-BETTER BACK RD	0.00	0.00	0.00%
01-5-703711.00 WOMEN'S CLUB GRANT	0.00	0.00	0.00%
01-5-703713.00 2017 VTRANS BIKE & PED GR	6,600.00	0.00	0.00%
01-5-703714.00 VT Trans - TAP Grant (Tig	75,600.00	2,638.43	3.49%
01-5-703715.00 VTRANS STRUCTURES GRNT	3,600.00	0.00	0.00%
<b>Total GRANTS</b>	<b>91,505.00</b>	<b>2,638.43</b>	<b>2.88%</b>
<b>Total HIGHWAY DIVISION</b>	<b>1,568,667.00</b>	<b>118,926.89</b>	<b>7.58%</b>
<b>01-5-704 BUILDINGS &amp; GROUNDS DIVIS</b>			
<b>01-5-7041 B &amp; G WAGES &amp; BENEFITS</b>			
01-5-704113.00 BUILDINGS & GROUNDS WAGES	92,372.00	12,854.72	13.92%
01-5-704114.00 OT BLDGS & GROUNDS	5,000.00	600.85	12.02%
01-5-704116.00 PAGER COMPENSATION	550.00	0.00	0.00%
01-5-704121.00 FICA	7,491.00	830.55	11.09%
01-5-704122.00 MEDICARE	0.00	194.25	100.00%
01-5-704123.00 HEALTH INSURANCE	31,866.00	8,687.67	27.26%
01-5-704124.00 DISABILITY/LIFE	1,140.00	261.30	22.92%
01-5-704125.00 DENTAL INSURANCE	735.00	165.17	22.47%
01-5-704126.00 RETIREMENT	5,631.00	807.33	14.34%
<b>Total B &amp; G WAGES &amp; BENEFITS</b>	<b>144,785.00</b>	<b>24,401.84</b>	<b>16.85%</b>
<b>01-5-7042 MATERIALS</b>			
01-5-704201.00 GARDEN SUPPLIES & PLANTS	2,000.00	0.00	0.00%
<b>Total MATERIALS</b>	<b>2,000.00</b>	<b>0.00</b>	<b>0.00%</b>

Account	Budget	Actual	% of Budget
<b>01-5-7043 CONTRACTED SERVICES</b>			
01-5-704301.00 FOLEY PARK & MEDIANS	0.00	0.00	0.00%
01-5-704311.00 UNIFORMS	2,500.00	636.89	25.48%
<b>Total CONTRACTED SERVICES</b>	<b>2,500.00</b>	<b>636.89</b>	<b>25.48%</b>
<b>01-5-7044 EQUIPMENT</b>			
01-5-704401.00 OUTSIDE REPAIRS	1,600.00	0.00	0.00%
01-5-704403.00 PARTS & SUPPLIES	3,000.00	161.94	5.40%
01-5-704405.00 PETROLEUM PRODUCTS	2,800.00	244.83	8.74%
01-5-704413.00 TOOLS	500.00	74.96	14.99%
<b>Total EQUIPMENT</b>	<b>7,900.00</b>	<b>481.73</b>	<b>6.10%</b>
<b>01-5-7046 CAPITAL EXPENDITURES</b>			
01-5-704601.00 DESIGNATED FUND-EQUIPMENT	0.00	0.00	0.00%
<b>Total CAPITAL EXPENDITURES</b>	<b>0.00</b>	<b>0.00</b>	<b>0.00%</b>
<b>Total BUILDINGS &amp; GROUNDS DIVIS</b>	<b>157,185.00</b>	<b>25,520.46</b>	<b>16.24%</b>
<b>01-5-705 SOLID WASTE DIVISION</b>			
<b>01-5-7051 SW WAGES &amp; BENEFITS</b>			
01-5-705112.00 TRNSF STATION WAGE	39,374.00	6,052.22	15.37%
01-5-705121.00 FICA TAX	3,012.00	375.21	12.46%
01-5-705122.00 MEDI TAX	0.00	87.78	100.00%
<b>Total SW WAGES &amp; BENEFITS</b>	<b>42,386.00</b>	<b>6,515.21</b>	<b>15.37%</b>
<b>01-5-7053 CONTRACTED SERVICES</b>			
01-5-705301.00 GUVSWMD ASSESSMENT	37,554.00	18,777.00	50.00%
01-5-705303.00 MUNICIPAL SOLID WASTE	43,000.00	5,406.27	12.57%
01-5-705305.00 RECYCLING	40,000.00	3,953.24	9.88%
01-5-705306.00 C & D WASTE DISPOSAL	10,000.00	0.00	0.00%
01-5-705307.00 HOUSEHOLD HAZARDOUS WASTE	0.00	0.00	0.00%
01-5-705308.00 FOOD WASTE DISPOSAL	6,000.00	1,521.92	25.37%
01-5-705311.00 UNIFORMS	500.00	0.00	0.00%
<b>Total CONTRACTED SERVICES</b>	<b>137,054.00</b>	<b>29,658.43</b>	<b>21.64%</b>
<b>01-5-7054 EQUIPMENT</b>			
01-5-705403.00 PARTS & SUPPLIES	1,000.00	68.12	6.81%
01-5-705405.00 ST OF VT GRANT	0.00	0.00	0.00%
01-5-705411.00 REPAIRS & MAINTENANCE	2,000.00	0.00	0.00%
01-5-705413.00 SMALL EQUIPMENT	300.00	0.00	0.00%
<b>Total EQUIPMENT</b>	<b>3,300.00</b>	<b>68.12</b>	<b>2.06%</b>
<b>01-5-7055 TRANSFER STATION</b>			

Account	Budget	Actual	% of Budget
01-5-705500.00 PURCHASED SERVICES	2,595.00	272.00	10.48%
01-5-705501.00 ELECTRICITY	2,000.00	270.00	13.50%
01-5-705503.00 PROPANE	600.00	0.00	0.00%
01-5-705505.00 TELEPHONE	450.00	37.93	8.43%
01-5-705515.00 ADMINISTRATION	2,000.00	0.00	0.00%
01-5-705517.00 VERMONT FRANCHISE TAX	2,000.00	0.00	0.00%
<b>Total TRANSFER STATION</b>	<b>9,645.00</b>	<b>579.93</b>	<b>6.01%</b>
<b>01-5-7056 CAPITAL EXPENDITURES</b>			
01-5-705601.00 DESIGNATED FUND-EQUIPMENT	0.00	0.00	0.00%
<b>Total CAPITAL EXPENDITURES</b>	<b>0.00</b>	<b>0.00</b>	<b>0.00%</b>
<b>Total SOLID WASTE DIVISION</b>	<b>192,385.00</b>	<b>36,821.69</b>	<b>19.14%</b>
<b>01-5-706 TRACY HALL</b>			
<b>01-5-7061 BUILDING EXPENSES</b>			
01-5-706100.00 WATER USAGE	650.00	0.00	0.00%
01-5-706101.00 ELECTRICITY	13,500.00	1,560.56	11.56%
01-5-706103.00 HEATING	11,500.00	0.00	0.00%
01-5-706105.00 ALARM MONITORING	600.00	125.00	20.83%
01-5-706107.00 ELEVATOR MAINTENANCE	3,300.00	540.80	16.39%
01-5-706108.00 CUSTODIAN PAGER & MILEAGE	550.00	0.00	0.00%
01-5-706109.00 BUILDING SUPPLIES	4,200.00	338.10	8.05%
01-5-706111.00 WOMEN'S CLUB GRANT	0.00	0.00	0.00%
01-5-706113.00 REPAIRS & MAINTENANCE	13,000.00	1,380.01	10.62%
01-5-706115.00 BNDSTND/SIGN/EVCH ELECTRI	2,000.00	258.06	12.90%
01-5-706115.10 EV Chg St @ Huntley Meado	0.00	0.00	0.00%
01-5-706117.00 DESIGNATED FUND-TRACY HAL	0.00	0.00	0.00%
<b>Total BUILDING EXPENSES</b>	<b>49,300.00</b>	<b>4,202.53</b>	<b>8.52%</b>
<b>Total TRACY HALL</b>	<b>49,300.00</b>	<b>4,202.53</b>	<b>8.52%</b>
<b>Total PUBLIC WORKS DEPT.</b>	<b>1,967,937.00</b>	<b>188,471.57</b>	<b>9.43%</b>
<b>01-5-8002 DEBT SERVICE EXPENDITURES</b>			
01-5-800205.00 TRACY HALL PRINCIPAL	0.00	0.00	0.00%
01-5-800207.00 PUBLIC SAFTY FACILITY BON	47,000.00	0.00	0.00%
01-5-800208.00 Browns SH Rd Bridge	0.00	0.00	0.00%
01-5-800235.00 DEBT INTEREST	47,416.00	0.00	0.00%
01-5-800236.00 DEBT INTEREST (FEMA)	0.00	0.00	0.00%
01-5-800237.00 LOC Principal Pmt	0.00	0.00	0.00%
01-5-800238.00 LOC Interest	0.00	0.00	0.00%
<b>Total DEBT SERVICE EXPENDITURES</b>	<b>94,416.00</b>	<b>0.00</b>	<b>0.00%</b>
<b>01-5-8003 APPROPRIATION EXPENDTURES</b>			
01-5-800302.00 NORWICH PUBLIC LIBRARY	288,660.00	0.00	0.00%

Account	Budget	Actual	% of Budget
01-5-800303.00 NORWICH PUBLIC LIBRARY RE	0.00	0.00	0.00%
01-5-800304.00 NORWICH SENIOR ACT COUNCL	0.00	0.00	0.00%
01-5-800306.00 NORWICH LIONS CLUB	3,000.00	0.00	0.00%
01-5-800308.00 NORWICH NEWSLETTER	0.00	0.00	0.00%
01-5-800310.00 NORWICH AMERICAN LEGION	1,500.00	0.00	0.00%
01-5-800314.00 NORWICH SPECIAL EVENTS	0.00	0.00	0.00%
01-5-800315.00 NORWICH HISTORICAL SOC.	8,000.00	0.00	0.00%
01-5-800316.00 NORWICH CEMETERY ASSOCATN	20,000.00	0.00	0.00%
01-5-800317.00 NORWICH CEMETERY-RESTORE	0.00	0.00	0.00%
01-5-800318.00 NORWICH AFFORDABLE HOUSIN	0.00	0.00	0.00%
01-5-800324.00 CHILD CARE CTR IN NORWICH	4,348.00	0.00	0.00%
01-5-800326.00 HCERS OF SE VERMONT	0.00	0.00	0.00%
01-5-800328.00 VSTNG NRS/HSP APPR	15,600.00	0.00	0.00%
01-5-800330.00 SERG	0.00	0.00	0.00%
01-5-800350.00 THE FAMILY PLACE	6,000.00	0.00	0.00%
01-5-800352.00 ADVANCE TRANSIT	13,514.00	0.00	0.00%
01-5-800354.00 HEADREST	2,500.00	0.00	0.00%
01-5-800356.00 WINDSOR COUNTY PARTNERS	1,000.00	0.00	0.00%
01-5-800358.00 CATV/6 APPROP	3,000.00	0.00	0.00%
01-5-800360.00 THE UPPER VALLEY HAVEN	0.00	0.00	0.00%
01-5-800362.00 WISE	2,500.00	0.00	0.00%
01-5-800364.00 RSVP	0.00	0.00	0.00%
01-5-800366.00 SEVCA	3,750.00	0.00	0.00%
01-5-800368.00 YOUTH-IN-ACTION	3,000.00	0.00	0.00%
01-5-800369.00 SENIOR SOLUTIONS	1,200.00	0.00	0.00%
01-5-800372.00 WHT RIVR COUN ON AGING	5,300.00	0.00	0.00%
01-5-800375.00 PUBLIC HEALTH COUNC UV	337.00	0.00	0.00%
01-5-800382.00 U.V. TRAILS ALLIANCE	2,000.00	0.00	0.00%
01-5-800384.00 VALLEY COURT DIVERSION PR	0.00	0.00	0.00%
01-5-800386.00 GOOD BEGINNINGS	3,000.00	0.00	0.00%
01-5-800388.00 GREEN MTN ECO DEV CORP	1,659.00	0.00	0.00%
01-5-800389.00 SPECIAL NEEDS SUPPORT CEN	2,000.00	0.00	0.00%
<b>Total APPROPRIATION EXPENDITURES</b>	<b>391,868.00</b>	<b>0.00</b>	<b>0.00%</b>
<b>01-5-8004 TAX EXPENDITURES</b>			
01-5-800408.00 TAX ABATEMENT/ADJUSTMENT	3,500.00	0.00	0.00%
01-5-800410.00 INTEREST	0.00	0.00	0.00%
<b>Total TAX EXPENDITURES</b>	<b>3,500.00</b>	<b>0.00</b>	<b>0.00%</b>
<b>01-5-8005 INSURANCE</b>			
01-5-800501.00 HRA ADMINISTRATION FEES	0.00	0.00	0.00%
01-5-800502.00 HEALTH REIMBURSEMENT ACCO	0.00	0.00	0.00%
01-5-800503.00 HEALTH INSURANCE	0.00	0.00	0.00%
01-5-800505.00 SOCIAL SECURITY TAX	0.00	0.00	0.00%
01-5-800506.00 COBRA	0.00	0.00	0.00%
01-5-800517.00 UNEMP INS RATE ASSMT	2,397.00	574.00	23.95%
01-5-800518.00 PROP & CAS INSURANCE	75,092.00	36,855.10	49.08%
01-5-800520.00 WORKER'S COMP INS	109,130.00	54,565.40	50.00%

Account	Budget	Actual	% of Budget
<b>Total INSURANCE</b>	<b>186,619.00</b>	<b>91,994.50</b>	<b>49.30%</b>
<b>Total Expenditures</b>	<b>4,908,740.00</b>	<b>644,934.71</b>	<b>13.14%</b>
<b>Total General</b>	<b>85,301.00</b>	<b>15,848,308.36</b>	
<b>Total All Funds</b>	<b>85,301.00</b>	<b>15,848,308.36</b>	

ADDITIONAL

9

09/17/20  
03:23 pm

Town of Norwich General Ledger  
Balance Sheet Current Year - Period 2 Aug  
CONSERVATION COMM FUND

Page 1 of 1  
nemrc support

Account	Curr Yr Pd 2 Aug Encumbrances	Curr Yr Pd 2 Aug Actual
<b>ASSET</b>		
04-1-001108.00 CASH-CONSERVATION COMM	0.00	0.00
04-1-001204.00 CASH-CD CONSERV. COMM	0.00	0.00
04-1-090000.00 DUE FROM/TO OTHER FUND	0.00	133,611.87
<b>Total Asset</b>	<b>0.00</b>	<b>133,611.87</b>
<b>LIABILITY</b>		
04-2-001160.00 YEAR END A/P	0.00	0.00
<b>Total Liability</b>	<b>0.00</b>	<b>0.00</b>
<b>FUND BALANCE</b>		
04-3-001300.00 FUND BALANCE-CONS COMM	0.00	133,611.87
<b>Total Prior Years Fund Balance</b>	<b>0.00</b>	<b>133,611.87</b>
Fund Balance Current Year	0.00	0.00
<b>Total Fund Balance</b>	<b>0.00</b>	<b>133,611.87</b>
<b>Total Liability, Reserves, Fund Balance</b>	<b>0.00</b>	<b>133,611.87</b>



09/17/20  
03:23 pm

Town of Norwich General Ledger  
Balance Sheet Current Year - Period 2 Aug  
RECREATION FACILITY & IMP

Page 1 of 1  
nemrc support

Account	Curr Yr Pd 2 Aug Encumbrances	Curr Yr Pd 2 Aug Actual
<b>ASSET</b>		
05-1-001102.00 CASH-RECREATION FUND	0.00	0.00
05-1-090000.00 DUE FROM/TO OTHER FUND	0.00	68,289.08
<b>Total Asset</b>	<b>0.00</b>	<b>68,289.08</b>
<b>LIABILITY</b>		
05-2-001160.00 ACCOUNTS PAYABLE	0.00	0.00
<b>Total Liability</b>	<b>0.00</b>	<b>0.00</b>
<b>FUND BALANCE</b>		
05-3-001300.00 FUND BALANCE-RECREATION	0.00	65,751.08
05-4-000801.00 Huntley Meadows Improveme	0.00	0.00
<b>Total Prior Years Fund Balance</b>	<b>0.00</b>	<b>65,751.08</b>
<b>Fund Balance Current Year</b>	<b>0.00</b>	<b>2,538.00</b>
<b>Total Fund Balance</b>	<b>0.00</b>	<b>68,289.08</b>
<b>Total Liability, Reserves, Fund Balance</b>	<b>0.00</b>	<b>68,289.08</b>

Account	Curr Yr Pd 2 Aug Encumbrances	Curr Yr Pd 2 Aug Actual
<b>ASSET</b>		
06-1-090000.00 DUE FROM/TO OTHER FUND	0.00	577,621.16
<b>Total Asset</b>	<b>0.00</b>	<b>577,621.16</b>
<b>FUND BALANCE</b>		
06-3-001300.00 FUND BALANCE-FIRE EQUIP	0.00	577,621.16
<b>Total Prior Years Fund Balance</b>	<b>0.00</b>	<b>577,621.16</b>
<b>Fund Balance Current Year</b>	<b>0.00</b>	<b>0.00</b>
<b>Total Fund Balance</b>	<b>0.00</b>	<b>577,621.16</b>
<b>Total Liability, Reserves, Fund Balance</b>	<b>0.00</b>	<b>577,621.16</b>

09/17/20  
03:23 pm

Town of Norwich General Ledger  
Balance Sheet Current Year - Period 2 Aug  
HIGHWAY EQUIPMENT FUND

Page 1 of 1  
nemrc support

Account	Curr Yr Pd 2 Aug Encumbrances	Curr Yr Pd 2 Aug Actual
<b>ASSET</b>		
07-1-003014.00 ACCOUNTS RECEIVABLE	0.00	0.00
07-1-090000.00 DUE FROM/TO OTHER FUND	0.00	188,641.12
<b>Total Asset</b>	<b>0.00</b>	<b>188,641.12</b>
<b>LIABILITY</b>		
07-2-000770.00 CAPITAL LEASE OBLIGATION	0.00	0.00
07-2-001120.00 GRANT ANTICIPATION LOAN	0.00	0.00
07-2-001160.00 A/P HIGHWAY EQUIP FUND	0.00	0.00
<b>Total Liability</b>	<b>0.00</b>	<b>0.00</b>
<b>FUND BALANCE</b>		
07-3-001300.00 FUND BALANCE-HWY EQUIP	0.00	188,641.12
<b>Total Prior Years Fund Balance</b>	<b>0.00</b>	<b>188,641.12</b>
Fund Balance Current Year	0.00	0.00
<b>Total Fund Balance</b>	<b>0.00</b>	<b>188,641.12</b>
<b>Total Liability, Reserves, Fund Balance</b>	<b>0.00</b>	<b>188,641.12</b>

09/17/20  
03:23 pm

Town of Norwich General Ledger  
Balance Sheet Current Year - Period 2 Aug  
HIGHWAY GARAGE FUND

Page 1 of 1  
nemrc support

Account	Curr Yr Pd 2 Aug Encumbrances	Curr Yr Pd 2 Aug Actual
<b>ASSET</b>		
08-1-001105.00 CASH-HWY GARAGE FUND	0.00	0.00
08-1-003024.00 A/R TOWN GARAGE	0.00	0.00
08-1-090000.00 DUE FROM/TO OTHER FUND	0.00	52,247.14
<b>Total Asset</b>	<b>0.00</b>	<b>52,247.14</b>
<b>LIABILITY</b>		
08-2-001120.00 GRANT ANTICIPATION LOAN	0.00	0.00
08-2-001140.00 FEMA GRANT RECEIVABLE	0.00	0.00
08-2-001160.00 ACCOUNTS PAYABLE	0.00	0.00
08-2-001162.00 DEFERRED GRANT REVENUE	0.00	0.00
<b>Total Liability</b>	<b>0.00</b>	<b>0.00</b>
<b>FUND BALANCE</b>		
08-3-001300.00 FUND BALANCE-HWY GARAGE	0.00	52,247.14
<b>Total Prior Years Fund Balance</b>	<b>0.00</b>	<b>52,247.14</b>
<b>Fund Balance Current Year</b>	<b>0.00</b>	<b>0.00</b>
<b>Total Fund Balance</b>	<b>0.00</b>	<b>52,247.14</b>
<b>Total Liability, Reserves, Fund Balance</b>	<b>0.00</b>	<b>52,247.14</b>

09/17/20  
03:23 pm

Town of Norwich General Ledger  
Balance Sheet Current Year - Period 2 Aug  
SOLID WASTE EQUIP FUND

Page 1 of 1  
nemrc support

Account	Curr Yr Pd 2 Aug Encumbrances	Curr Yr Pd 2 Aug Actual
<b>ASSET</b>		
09-1-090000.00 DUE FROM/TO OTHER FUND	0.00	34,048.19
<b>Total Asset</b>	<b>0.00</b>	<b>34,048.19</b>
<b>LIABILITY</b>		
09-2-001160.00 A/P SOLID WASTE FUND	0.00	0.00
<b>Total Liability</b>	<b>0.00</b>	<b>0.00</b>
<b>FUND BALANCE</b>		
09-3-001300.00 FUND BALANCE-SOLID WASTE	0.00	34,048.19
<b>Total Prior Years Fund Balance</b>	<b>0.00</b>	<b>34,048.19</b>
Fund Balance Current Year	0.00	0.00
<b>Total Fund Balance</b>	<b>0.00</b>	<b>34,048.19</b>
<b>Total Liability, Reserves, Fund Balance</b>	<b>0.00</b>	<b>34,048.19</b>

Account	Curr Yr Pd 2 Aug Encumbrances	Curr Yr Pd 2 Aug Actual
<b>ASSET</b>		
10-1-090000.00 DUE FROM/TO OTHER FUND	0.00	10,667.55
<b>Total Asset</b>	<b>0.00</b>	<b>10,667.55</b>
<b>LIABILITY</b>		
10-2-001160.00 A/P POLICE STATION FUND	0.00	0.00
<b>Total Liability</b>	<b>0.00</b>	<b>0.00</b>
<b>FUND BALANCE</b>		
10-3-001300.00 FUND BALANCE-POLICE STAT	0.00	10,667.55
<b>Total Prior Years Fund Balance</b>	<b>0.00</b>	<b>10,667.55</b>
Fund Balance Current Year	0.00	0.00
<b>Total Fund Balance</b>	<b>0.00</b>	<b>10,667.55</b>
<b>Total Liability, Reserves, Fund Balance</b>	<b>0.00</b>	<b>10,667.55</b>

Account	Curr Yr Pd 2 Aug Encumbrances	Curr Yr Pd 2 Aug Actual
<b>ASSET</b>		
11-1-090000.00 DUE FROM/TO OTHER FUNDS	0.00	91,032.23
<b>Total Asset</b>	<b>0.00</b>	<b>91,032.23</b>
<b>FUND BALANCE</b>		
11-3-001300.00 FUND BALANCE- POLICE CRUI	0.00	91,032.23
<b>Total Prior Years Fund Balance</b>	<b>0.00</b>	<b>91,032.23</b>
<b>Fund Balance Current Year</b>	<b>0.00</b>	<b>0.00</b>
<b>Total Fund Balance</b>	<b>0.00</b>	<b>91,032.23</b>
<b>Total Liability, Reserves, Fund Balance</b>	<b>0.00</b>	<b>91,032.23</b>

Account	Curr Yr Pd 2 Aug Encumbrances	Curr Yr Pd 2 Aug Actual
<b>ASSET</b>		
12-1-090000.00 DUE FROM/TO OTHER FUND	0.00	28,148.50
<b>Total Asset</b>	<b>0.00</b>	<b>28,148.50</b>
<b>LIABILITY</b>		
12-2-001160.00 ACCOUNTS PAYABLE	0.00	0.00
<b>Total Liability</b>	<b>0.00</b>	<b>0.00</b>
<b>FUND BALANCE</b>		
12-3-001300.00 FUND BALANCE-REAPPRAISAL	0.00	28,148.50
<b>Total Prior Years Fund Balance</b>	<b>0.00</b>	<b>28,148.50</b>
Fund Balance Current Year	0.00	0.00
<b>Total Fund Balance</b>	<b>0.00</b>	<b>28,148.50</b>
<b>Total Liability, Reserves, Fund Balance</b>	<b>0.00</b>	<b>28,148.50</b>



Account	Curr Yr Pd 2 Aug Encumbrances	Curr Yr Pd 2 Aug Actual
<b>ASSET</b>		
13-1-003108.00 GRANT RECEIVABLE	0.00	0.00
13-1-090000.00 DUE FROM/TO OTHER FUND	0.00	65,945.03
<b>Total Asset</b>	<b>0.00</b>	<b>65,945.03</b>
<b>LIABILITY</b>		
13-2-001160.00 ACCOUNTS PAYABLE	0.00	0.00
<b>Total Liability</b>	<b>0.00</b>	<b>0.00</b>
<b>FUND BALANCE</b>		
13-3-001300.00 FUND BALANCE-TRACY HALL	0.00	65,945.03
<b>Total Prior Years Fund Balance</b>	<b>0.00</b>	<b>65,945.03</b>
<b>Fund Balance Current Year</b>	<b>0.00</b>	<b>0.00</b>
<b>Total Fund Balance</b>	<b>0.00</b>	<b>65,945.03</b>
<b>Total Liability, Reserves, Fund Balance</b>	<b>0.00</b>	<b>65,945.03</b>

Account	Curr Yr Pd 2 Aug Encumbrances	Curr Yr Pd 2 Aug Actual
<b>ASSET</b>		
14-1-090000.00 DUE FROM/TO OTHER FUNDS	0.00	33,053.68
<b>Total Asset</b>	<b>0.00</b>	<b>33,053.68</b>
<b>LIABILITY</b>		
14-2-001160.00 ACCOUNTS PAYABLE	0.00	-1,780.00
<b>Total Liability</b>	<b>0.00</b>	<b>-1,780.00</b>
<b>FUND BALANCE</b>		
14-3-001300.00 FUND BALANCE-GEN ADMIN	0.00	34,833.68
<b>Total Prior Years Fund Balance</b>	<b>0.00</b>	<b>34,833.68</b>
<b>Fund Balance Current Year</b>	<b>0.00</b>	<b>0.00</b>
<b>Total Fund Balance</b>	<b>0.00</b>	<b>34,833.68</b>
<b>Total Liability, Reserves, Fund Balance</b>	<b>0.00</b>	<b>33,053.68</b>

Town of Norwich General Ledger  
Balance Sheet Current Year - Period 2 Aug  
Granite bench with crysta

Account	Curr Yr Pd 2 Aug Encumbrances	Curr Yr Pd 2 Aug Actual
<b>ASSET</b>		
15-1-090000.00 DUE FROM/TO OTHER FUND	0.00	1,528.45
<b>Total Asset</b>	<b>0.00</b>	<b>1,528.45</b>
<b>LIABILITY</b>		
15-2-001160.00 ACCOUNTS PAYABLE	0.00	0.00
<b>Total Liability</b>	<b>0.00</b>	<b>0.00</b>
<b>FUND BALANCE</b>		
15-3-001300.00 GENERAL FUND BAL-UNREST	0.00	1,528.45
<b>Total Prior Years Fund Balance</b>	<b>0.00</b>	<b>1,528.45</b>
<b>Fund Balance Current Year</b>	<b>0.00</b>	<b>0.00</b>
<b>Total Fund Balance</b>	<b>0.00</b>	<b>1,528.45</b>
<b>Total Liability, Reserves, Fund Balance</b>	<b>0.00</b>	<b>1,528.45</b>

Account	Curr Yr Pd 2 Aug Encumbrances	Curr Yr Pd 2 Aug Actual
<b>ASSET</b>		
16-1-090000.00 DUE FROM/TO OTHER FUNDS	0.00	1,297.76
<b>Total Asset</b>	<b>0.00</b>	<b>1,297.76</b>
<b>LIABILITY</b>		
16-2-001160.00 A/P DAM FUND	0.00	0.00
<b>Total Liability</b>	<b>0.00</b>	<b>0.00</b>
<b>FUND BALANCE</b>		
16-3-001300.00 FUND BALANCE-REC. DAM	0.00	1,297.76
<b>Total Prior Years Fund Balance</b>	<b>0.00</b>	<b>1,297.76</b>
<b>Fund Balance Current Year</b>	<b>0.00</b>	<b>0.00</b>
<b>Total Fund Balance</b>	<b>0.00</b>	<b>1,297.76</b>
<b>Total Liability, Reserves, Fund Balance</b>	<b>0.00</b>	<b>1,297.76</b>

Account	Curr Yr Pd 2 Aug Encumbrances	Curr Yr Pd 2 Aug Actual
<b>ASSET</b>		
17-1-090000.00 DUE FROM/TO OTHER FUND	0.00	8,309.51
<b>Total Asset</b>	<b>0.00</b>	<b>8,309.51</b>
<b>LIABILITY</b>		
17-2-001160.00 ACCOUNTS PAYABLE	0.00	0.00
<b>Total Liability</b>	<b>0.00</b>	<b>0.00</b>
<b>FUND BALANCE</b>		
17-3-001300.00 FUND BALANCE-TENNIS COURT	0.00	8,309.51
<b>Total Prior Years Fund Balance</b>	<b>0.00</b>	<b>8,309.51</b>
<b>Fund Balance Current Year</b>	<b>0.00</b>	<b>0.00</b>
<b>Total Fund Balance</b>	<b>0.00</b>	<b>8,309.51</b>
<b>Total Liability, Reserves, Fund Balance</b>	<b>0.00</b>	<b>8,309.51</b>

Account	Curr Yr Pd 2 Aug Encumbrances	Curr Yr Pd 2 Aug Actual
<b>ASSET</b>		
19-1-090000.00 DUE FROM/TO OTHER FUND	0.00	0.00
<b>Total Asset</b>	<b>0.00</b>	<b>0.00</b>
<b>LIABILITY</b>		
19-2-001160.00 Accounts Payable	0.00	0.00
<b>Total Liability</b>	<b>0.00</b>	<b>0.00</b>
<b>FUND BALANCE</b>		
19-3-001300.00 FUND BALANCE-TWN CLK EQUI	0.00	0.00
<b>Total Prior Years Fund Balance</b>	<b>0.00</b>	<b>0.00</b>
<b>Fund Balance Current Year</b>	<b>0.00</b>	<b>0.00</b>
<b>Total Fund Balance</b>	<b>0.00</b>	<b>0.00</b>
<b>Total Liability, Reserves, Fund Balance</b>	<b>0.00</b>	<b>0.00</b>

09/17/20  
03:23 pm

Town of Norwich General Ledger  
Balance Sheet Current Year - Period 2 Aug  
POLICE SPEC EQUIP FUND

Page 1  
nemrc support

Account	Curr Yr Pd 2 Aug Encumbrances	Curr Yr Pd 2 Aug Actual
-----		
ASSET		
21-1-003106.00 GRANT RECEIVABLE	0.00	0.00
21-1-090000.00 DUE FROM/TO OTHER FUNDS	0.00	5,498.88
Total Asset	0.00	5,498.88
	=====	=====
FUND BALANCE		
21-3-001300.00 FUND BALANCE-POLICE SPEC	0.00	5,498.88
Total Prior Years Fund Balance	0.00	5,498.88
	-----	-----
Fund Balance Current Year	0.00	0.00
	-----	-----
Total Fund Balance	0.00	5,498.88
	-----	-----
Total Liability, Reserves, Fund Balance	0.00	5,498.88
	=====	=====

09/17/20  
03:23 pm

Town of Norwich General Ledger  
Balance Sheet Current Year - Period 2 Aug  
KIDS & COPS FUND

Account	Curr Yr Pd 2 Aug Encumbrances	Curr Yr Pd 2 Aug Actual
-----		
ASSET		
22-1-090000.00 DUE FROM/TO OTHER FUND	0.00	0.00
Total Asset	0.00	0.00
=====		
FUND BALANCE		
22-3-001300.00 FUND BALANCE-KIDS & COPS	0.00	0.00
Total Prior Years Fund Balance	0.00	0.00
Fund Balance Current Year	0.00	0.00
Total Fund Balance	0.00	0.00
Total Liability, Reserves, Fund Balance	0.00	0.00
=====		



09/17/20  
03:23 pm

Town of Norwich General Ledger  
Balance Sheet Current Year - Period 2 Aug  
AFFORDABLE HOUSING FUND

Account	Curr Yr Pd 2 Aug Encumbrances	Curr Yr Pd 2 Aug Actual
<b>ASSET</b>		
23-1-090000.00 DUE/FROM TO OTHER FUND	0.00	46,298.64
Total Asset	0.00	46,298.64
<b>FUND BALANCE</b>		
23-3-001300.00 FUND BALANCE-AFFORDABLE H	0.00	46,298.64
Total Prior Years Fund Balance	0.00	46,298.64
Fund Balance Current Year	0.00	0.00
Total Fund Balance	0.00	46,298.64
Total Liability, Reserves, Fund Balance	0.00	46,298.64

Town of Norwich General Ledger  
Balance Sheet Current Year - Period 2 Aug  
LAND MANAGEMENT COUNCIL F

Account	Curr Yr Pd 2 Aug Encumbrances	Curr Yr Pd 2 Aug Actual
<b>ASSET</b>		
24-1-001104.00 CASH-CD LAND MGMT COUNCIL	0.00	0.00
24-1-090000.00 DUE FROM/TO OTHER FUNDS	0.00	9,978.03
<b>Total Asset</b>	<b>0.00</b>	<b>9,978.03</b>
<b>FUND BALANCE</b>		
24-3-001300.00 FUND BALANCE-LAND MGMT CO	0.00	9,126.40
<b>Total Prior Years Fund Balance</b>	<b>0.00</b>	<b>9,126.40</b>
<b>Fund Balance Current Year</b>	<b>0.00</b>	<b>851.63</b>
<b>Total Fund Balance</b>	<b>0.00</b>	<b>9,978.03</b>
<b>Total Liability,Reserves,Fund Balance</b>	<b>0.00</b>	<b>9,978.03</b>

Town of Norwich General Ledger  
Balance Sheet Current Year - Period 2 Aug  
FIRE STATION FUND

Account	Curr Yr Pd 2 Aug Encumbrances	Curr Yr Pd 2 Aug Actual
<b>ASSET</b>		
25-1-090000.00 DUE/FROM TO OTHER FUND	0.00	231.40
<b>Total Asset</b>	<b>0.00</b>	<b>231.40</b>
<b>LIABILITY</b>		
25-2-001160.00 ACCOUNTS PAYABLE	0.00	0.00
<b>Total Liability</b>	<b>0.00</b>	<b>0.00</b>
<b>FUND BALANCE</b>		
25-3-001300.00 FUND BALANCE-FIRE STATION	0.00	231.40
<b>Total Prior Years Fund Balance</b>	<b>0.00</b>	<b>231.40</b>
<b>Fund Balance Current Year</b>	<b>0.00</b>	<b>0.00</b>
<b>Total Fund Balance</b>	<b>0.00</b>	<b>231.40</b>
<b>Total Liability, Reserves, Fund Balance</b>	<b>0.00</b>	<b>231.40</b>

09/17/20  
03:23 pm

Town of Norwich General Ledger  
Balance Sheet Current Year - Period 2 Aug  
FIRE EQUIPMENT FUND

Page 1  
nemrc support

Account	Curr Yr Pd 2 Aug Encumbrances	Curr Yr Pd 2 Aug Actual
<hr/>		
<b>ASSET</b>		
26-1-090000.00 DUE FROM/TO OTHER FUND	0.00	105,821.94
Total Asset	0.00	105,821.94
<hr/>		
<b>FUND BALANCE</b>		
26-3-001300.00 FUND BALANCE-FIRE EQUIPME	0.00	105,821.94
Total Prior Years Fund Balance	0.00	105,821.94
Fund Balance Current Year	0.00	0.00
Total Fund Balance	0.00	105,821.94
Total Liability, Reserves, Fund Balance	0.00	105,821.94
<hr/>		

09/17/20  
03:23 pm

Town of Norwich General Ledger  
Balance Sheet Current Year - Period 2 Aug  
SIDEWALK FUND

Page 1  
nemrc support

Account	Curr Yr Pd 2 Aug Encumbrances	Curr Yr Pd 2 Aug Actual
-----		
ASSET		
27-1-090000.00 DUE FROM/TO OTHER FUND	0.00	80,865.33
	-----	-----
Total Asset	0.00	80,865.33
	=====	=====
FUND BALANCE		
27-3-001300.00 FUND BALANCE-SIDEWALK FUN	0.00	80,865.33
	-----	-----
Total Prior Years Fund Balance	0.00	80,865.33
	-----	-----
Fund Balance Current Year	0.00	0.00
	-----	-----
Total Fund Balance	0.00	80,865.33
	-----	-----
Total Liability, Reserves, Fund Balance	0.00	80,865.33
	=====	=====

Account	Curr Yr Pd 2 Aug Encumbrances	Curr Yr Pd 2 Aug Actual
<b>ASSET</b>		
28-1-090000.00 DUE FROM/TO OTHER FUND	0.00	546.59
<b>Total Asset</b>	<b>0.00</b>	<b>546.59</b>
<b>LIABILITY</b>		
28-2-001160.00 ACCOUNTS PAYABLE	0.00	0.00
28-3-001300.00 FUND BALANCE-FACILITY STU	0.00	546.59
<b>Total Liability</b>	<b>0.00</b>	<b>546.59</b>
<b>Fund Balance Current Year</b>	<b>0.00</b>	<b>0.00</b>
<b>Total Fund Balance</b>	<b>0.00</b>	<b>0.00</b>
<b>Total Liability,Reserves,Fund Balance</b>	<b>0.00</b>	<b>546.59</b>

09/17/20  
03:23 pm

Town of Norwich General Ledger  
Balance Sheet Current Year - Period 2 Aug  
TOWN MANAGER VEHICLE FUND

Account	Curr Yr Pd 2 Aug Encumbrances	Curr Yr Pd 2 Aug Actual
<b>ASSET</b>		
29-1-090000.00 DUE FROM/TO OTHER FUND	0.00	0.00
Total Asset	0.00	0.00
<b>LIABILITY</b>		
29-3-001300.00 FUND BALANCETMGR VEHICLE	0.00	0.00
Total Liability	0.00	0.00
Fund Balance Current Year	0.00	0.00
Total Fund Balance	0.00	0.00
Total Liability, Reserves, Fund Balance	0.00	0.00

Town of Norwich General Ledger  
Balance Sheet Current Year - Period 2 Aug  
BANDSTAND RENOVATION FUND

Account	Curr Yr Pd 2 Aug Encumbrances	Curr Yr Pd 2 Aug Actual
<b>ASSET</b>		
30-1-090000.00 DUE FROM/TO OTHER FUND	0.00	4.19
<b>Total Asset</b>	<b>0.00</b>	<b>4.19</b>
<b>LIABILITY</b>		
30-2-001160.00 ACCCOUNTS PAYABLE	0.00	0.00
30-3-001300.00 FUND BALANCE-BANDSTAND RE	0.00	4.19
<b>Total Liability</b>	<b>0.00</b>	<b>4.19</b>
<b>Fund Balance Current Year</b>	<b>0.00</b>	<b>0.00</b>
<b>Total Fund Balance</b>	<b>0.00</b>	<b>0.00</b>
<b>Total Liability, Reserves, Fund Balance</b>	<b>0.00</b>	<b>4.19</b>



Town of Norwich General Ledger  
Balance Sheet Current Year - Period 2 Aug  
COMMUNICATIONS STUDY FUND

Account	Curr Yr Pd 2 Aug Encumbrances	Curr Yr Pd 2 Aug Actual
<b>ASSET</b>		
31-1-090000.00 DUE FROM/TO OTHER FUNDS	0.00	0.00
<b>Total Asset</b>	<b>0.00</b>	<b>0.00</b>
<b>FUND BALANCE</b>		
31-3-001300.00 FUND BALANCE-COMMUN STUDY	0.00	0.00
<b>Total Prior Years Fund Balance</b>	<b>0.00</b>	<b>0.00</b>
<b>Fund Balance Current Year</b>	<b>0.00</b>	<b>0.00</b>
<b>Total Fund Balance</b>	<b>0.00</b>	<b>0.00</b>
<b>Total Liability, Reserves, Fund Balance</b>	<b>0.00</b>	<b>0.00</b>

Account	Curr Yr Pd 2 Aug Encumbrances	Curr Yr Pd 2 Aug Actual
<b>ASSET</b>		
33-1-090000.00 DUE FROM/TO OTHER FUND	0.00	6,792.37
<b>Total Asset</b>	<b>0.00</b>	<b>6,792.37</b>
<b>FUND BALANCE</b>		
33-3-001300.00 FUND BAL-RESTRICT	0.00	7,492.37
<b>Total Prior Years Fund Balance</b>	<b>0.00</b>	<b>7,492.37</b>
<b>Fund Balance Current Year</b>	<b>0.00</b>	<b>-700.00</b>
<b>Total Fund Balance</b>	<b>0.00</b>	<b>6,792.37</b>
<b>Total Liability, Reserves, Fund Balance</b>	<b>0.00</b>	<b>6,792.37</b>

09/17/20  
03:23 pm

Town of Norwich General Ledger  
Balance Sheet Current Year - Period 2 Aug  
WCTU FOUNTAIN

Account	Curr Yr Pd 2 Aug Encumbrances	Curr Yr Pd 2 Aug Actual
<b>ASSET</b>		
34-1-090000.00 DUE FROM/TO OTHER FUND	0.00	1,101.53
<b>Total Asset</b>	0.00	1,101.53
<b>FUND BALANCE</b>		
34-3-001300.00 FUND BALANCE	0.00	1,101.53
<b>Total Prior Years Fund Balance</b>	0.00	1,101.53
<b>Fund Balance Current Year</b>	0.00	0.00
<b>Total Fund Balance</b>	0.00	1,101.53
<b>Total Liability, Reserves, Fund Balance</b>	0.00	1,101.53

09/17/20  
03:23 pm

Town of Norwich General Ledger  
Balance Sheet Current Year - Period 2 Aug  
CORRIDOR TREE

Account	Curr Yr Pd 2 Aug Encumbrances	Curr Yr Pd 2 Aug Actual
<hr/>		
<b>ASSET</b>		
35-1-090000.00 DUE FROM/TO OTHER FUND	0.00	0.00
	-----	-----
<b>Total Asset</b>	<b>0.00</b>	<b>0.00</b>
	=====	=====
 <b>FUND BALANCE</b>		
35-3-001300.00 FUND BALANCE	0.00	0.00
	-----	-----
<b>Total Prior Years Fund Balance</b>	<b>0.00</b>	<b>0.00</b>
	-----	-----
<b>Fund Balance Current Year</b>	<b>0.00</b>	<b>0.00</b>
	-----	-----
<b>Total Fund Balance</b>	<b>0.00</b>	<b>0.00</b>
	-----	-----
<b>Total Liability, Reserves, Fund Balance</b>	<b>0.00</b>	<b>0.00</b>
	=====	=====

Account	Curr Yr Pd 2 Aug Encumbrances	Curr Yr Pd 2 Aug Actual
<b>ASSET</b>		
36-1-090000.00 DUE FROM/TO OTHER FUND	0.00	106.35
<b>Total Asset</b>	<b>0.00</b>	<b>106.35</b>
<b>FUND BALANCE</b>		
36-3-001300.00 FUND BALANCE	0.00	106.35
<b>Total Prior Years Fund Balance</b>	<b>0.00</b>	<b>106.35</b>
<b>Fund Balance Current Year</b>	<b>0.00</b>	<b>0.00</b>
<b>Total Fund Balance</b>	<b>0.00</b>	<b>106.35</b>
<b>Total Liability, Reserves, Fund Balance</b>	<b>0.00</b>	<b>106.35</b>

Account	Curr Yr Pd 2 Aug Encumbrances	Curr Yr Pd 2 Aug Actual
<b>ASSET</b>		
37-1-090000.00 DUE FROM/TO OTHER FUND	0.00	1,333.38
<b>Total Asset</b>	0.00	1,333.38
<b>LIABILITY</b>		
37-2-001160.00 ACCOUNTS PAYABLE	0.00	0.00
<b>Total Liability</b>	0.00	0.00
<b>FUND BALANCE</b>		
37-3-001300.00 FUND BALANCE	0.00	1,333.38
<b>Total Prior Years Fund Balance</b>	0.00	1,333.38
<b>Fund Balance Current Year</b>	0.00	0.00
<b>Total Fund Balance</b>	0.00	1,333.38
<b>Total Liability, Reserves, Fund Balance</b>	0.00	1,333.38

09/17/20  
03:23 pm

Town of Norwich General Ledger  
Balance Sheet Current Year - Period 2 Aug  
SCHOOL LEASELAND

Page 1  
nemrc support

Account	Curr Yr Pd 2 Aug Encumbrances	Curr Yr Pd 2 Aug Actual
-----		
ASSET		
38-1-090000.00 DUE FROM/TO OTHER FUND	0.00	0.00
Total Asset	0.00	0.00
	=====	=====
FUND BALANCE		
38-3-001300.00 FUND BALANCE	0.00	0.00
Total Prior Years Fund Balance	0.00	0.00
	-----	-----
Fund Balance Current Year	0.00	0.00
Total Fund Balance	0.00	0.00
	-----	-----
Total Liability, Reserves, Fund Balance	0.00	0.00
	=====	=====

Account	Curr Yr Pd 2 Aug Encumbrances	Curr Yr Pd 2 Aug Actual
<hr/>		
ASSET		
39-1-090000.00 DUE FROM/TO OTHER FUND	0.00	0.00
Total Asset	0.00	0.00
<hr/>		
FUND BALANCE		
39-3-001300.00 FUND BALANCE	0.00	0.00
Total Prior Years Fund Balance	0.00	0.00
Fund Balance Current Year	0.00	0.00
Total Fund Balance	0.00	0.00
Total Liability, Reserves, Fund Balance	0.00	0.00
<hr/>		



Account	Curr Yr Pd 2 Aug Encumbrances	Curr Yr Pd 2 Aug Actual
<b>ASSET</b>		
40-1-090000.00 DUE FROM/TO OTHER FUND	0.00	5,051.20
<b>Total Asset</b>	<b>0.00</b>	<b>5,051.20</b>
<b>FUND BALANCE</b>		
40-3-001300.00 FUND BAL-Restricted	0.00	5,051.20
<b>Total Prior Years Fund Balance</b>	<b>0.00</b>	<b>5,051.20</b>
<b>Fund Balance Current Year</b>	<b>0.00</b>	<b>0.00</b>
<b>Total Fund Balance</b>	<b>0.00</b>	<b>5,051.20</b>
<b>Total Liability, Reserves, Fund Balance</b>	<b>0.00</b>	<b>5,051.20</b>

Account	Curr Yr Pd 2 Aug Encumbrances	Curr Yr Pd 2 Aug Actual
<b>ASSET</b>		
41-1-003001.00 FEMA GRANT RECEIVABLE	0.00	5,447.08
41-1-003002.00 ST OF VT GRANT RECEIVABLE	0.00	0.00
41-1-090000.00 DUE FROM/TO OTHER FUND	0.00	332,794.90
<b>Total Asset</b>	<b>0.00</b>	<b>338,241.98</b>
<b>LIABILITY</b>		
41-2-001162.00 DEFERRED GRANT REVENUE	0.00	0.00
<b>Total Liability</b>	<b>0.00</b>	<b>0.00</b>
<b>FUND BALANCE</b>		
41-3-001300.00 GENERAL FUND BAL-UNREST	0.00	338,241.98
<b>Total Prior Years Fund Balance</b>	<b>0.00</b>	<b>338,241.98</b>
<b>Fund Balance Current Year</b>	<b>0.00</b>	<b>0.00</b>
<b>Total Fund Balance</b>	<b>0.00</b>	<b>338,241.98</b>
<b>Total Liability, Reserves, Fund Balance</b>	<b>0.00</b>	<b>338,241.98</b>

Account	Curr Yr Pd 2 Aug Encumbrances	Curr Yr Pd 2 Aug Actual
<b>ASSET</b>		
42-1-090000.00 DUE FROM/TO OTHER FUND	0.00	172,899.54
<b>Total Asset</b>	<b>0.00</b>	<b>172,899.54</b>
<b>LIABILITY</b>		
42-2-001160.00 Accounts Payable	0.00	0.00
<b>Total Liability</b>	<b>0.00</b>	<b>0.00</b>
<b>FUND BALANCE</b>		
42-3-001300.00 GENERAL FUND BAL-UNREST	0.00	172,899.54
<b>Total Prior Years Fund Balance</b>	<b>0.00</b>	<b>172,899.54</b>
<b>Fund Balance Current Year</b>	<b>0.00</b>	<b>0.00</b>
<b>Total Fund Balance</b>	<b>0.00</b>	<b>172,899.54</b>
<b>Total Liability, Reserves, Fund Balance</b>	<b>0.00</b>	<b>172,899.54</b>

Town of Norwich General Ledger  
Balance Sheet Current Year - Period 2 Aug  
BUILDINGS & GROUNDS

Account	Curr Yr Pd 2 Aug Encumbrances	Curr Yr Pd 2 Aug Actual
<b>ASSET</b>		
43-1-090000.00 DUE FROM/TO OTHER FUND	0.00	33,719.85
<b>Total Asset</b>	<b>0.00</b>	<b>33,719.85</b>
<b>FUND BALANCE</b>		
43-3-001300.00 GENERAL FUND BAL-UNREST	0.00	33,719.85
<b>Total Prior Years Fund Balance</b>	<b>0.00</b>	<b>33,719.85</b>
<b>Fund Balance Current Year</b>	<b>0.00</b>	<b>0.00</b>
<b>Total Fund Balance</b>	<b>0.00</b>	<b>33,719.85</b>
<b>Total Liability, Reserves, Fund Balance</b>	<b>0.00</b>	<b>33,719.85</b>

Account	Curr Yr Pd 2 Aug Encumbrances	Curr Yr Pd 2 Aug Actual
<b>ASSET</b>		
44-1-001100.00 MASCOMA BANK	0.00	0.00
44-1-001200.00 CASH-US Bank	0.00	0.00
44-1-001202.00 LEDYARD SAVINGS ACCT.	0.00	0.00
44-1-003105.00 A/R BOND PROCEEDS	0.00	0.00
44-1-003106.00 GRANT REC-HOMELAND SECURI	0.00	0.00
44-1-090000.00 DUE FROM/TO OTHER FUND	0.00	34.41
<b>Total Asset</b>	<b>0.00</b>	<b>34.41</b>
<b>LIABILITY</b>		
44-2-001120.00 TAX EXEMPT LEASE PURCHASE	0.00	0.00
44-2-001122.00 TOWER BOND-VMBB	0.00	0.00
44-2-001160.00 ACCOUNTS PAYABLE	0.00	0.00
<b>Total Liability</b>	<b>0.00</b>	<b>0.00</b>
<b>FUND BALANCE</b>		
44-3-001300.00 GENERAL FUND BAL-UNREST	0.00	34.41
<b>Total Prior Years Fund Balance</b>	<b>0.00</b>	<b>34.41</b>
<b>Fund Balance Current Year</b>	<b>0.00</b>	<b>0.00</b>
<b>Total Fund Balance</b>	<b>0.00</b>	<b>34.41</b>
<b>Total Liability, Reserves, Fund Balance</b>	<b>0.00</b>	<b>34.41</b>

Town of Norwich General Ledger  
Balance Sheet Current Year - Period 2 Aug  
RECORDS RESTORATION

Account	Curr Yr Pd 2 Aug Encumbrances	Curr Yr Pd 2 Aug Actual
<b>ASSET</b>		
45-1-090000.00 DUE FROM/TO OTHER FUND	0.00	28,497.64
<b>Total Asset</b>	<b>0.00</b>	<b>28,497.64</b>
<b>FUND BALANCE</b>		
45-3-001300.00 GENERAL FUND BAL-UNREST	0.00	25,870.64
<b>Total Prior Years Fund Balance</b>	<b>0.00</b>	<b>25,870.64</b>
<b>Fund Balance Current Year</b>	<b>0.00</b>	<b>2,627.00</b>
<b>Total Fund Balance</b>	<b>0.00</b>	<b>28,497.64</b>
<b>Total Liability, Reserves, Fund Balance</b>	<b>0.00</b>	<b>28,497.64</b>

Account	Curr Yr Pd 2 Aug Encumbrances	Curr Yr Pd 2 Aug Actual
<b>ASSET</b>		
46-1-090000.00 DUE FROM/TO OTHER FUND	0.00	48,380.51
<b>Total Asset</b>	<b>0.00</b>	<b>48,380.51</b>
<b>FUND BALANCE</b>		
46-3-001300.00 FUND BALANCE	0.00	48,380.51
<b>Total Prior Years Fund Balance</b>	<b>0.00</b>	<b>48,380.51</b>
<b>Fund Balance Current Year</b>	<b>0.00</b>	<b>0.00</b>
<b>Total Fund Balance</b>	<b>0.00</b>	<b>48,380.51</b>
<b>Total Liability, Reserves, Fund Balance</b>	<b>0.00</b>	<b>48,380.51</b>

Account	Curr Yr Pd 2 Aug Encumbrances	Curr Yr Pd 2 Aug Actual
<b>ASSET</b>		
47-1-001400.00 CASH- US BANK BOND	0.00	0.00
47-1-003014.00 ACCOUNTS RECEIVABLE	0.00	0.00
47-1-090000.00 DUE FROM/TO OTHER FUND	0.00	0.00
<b>Total Asset</b>	<b>0.00</b>	<b>0.00</b>
<b>LIABILITY</b>		
47-2-001160.00 ACCOUNTS PAYABLE	0.00	0.00
<b>Total Liability</b>	<b>0.00</b>	<b>0.00</b>
<b>FUND BALANCE</b>		
47-3-001300.00 GENERAL FUND BAL-UNREST	0.00	0.00
<b>Total Prior Years Fund Balance</b>	<b>0.00</b>	<b>0.00</b>
<b>Fund Balance Current Year</b>	<b>0.00</b>	<b>0.00</b>
<b>Total Fund Balance</b>	<b>0.00</b>	<b>0.00</b>
<b>Total Liability, Reserves, Fund Balance</b>	<b>0.00</b>	<b>0.00</b>



Budget Guidance Memo

From: Claudette

To: Norwich Selectboard, Herb Durfee III

September 18, 2020

**Background:**

This year has the town, state and nation dealing with an unprecedented world-wide pandemic. The long-term economic impact of the pandemic has yet to be fully realized, but in the short term, businesses have been reeling and residents left unemployed. In Norwich we have been lucky and somewhat insulated from the economic downturn. However, in August, 32 residents were unemployed (<http://www.vtlmi.info/laus.pdf>). This number does not accurately reflect the number of residents negatively impacted by the corona virus. Business owners and others who are self-employed are not reflected in these numbers. The State of Vermont has acknowledged that there is no valid and verifiable data on the total number of residents negatively impacted by COVID-19.

The State of Vermont has a current fiscal year 2021 General Fund budget deficit of \$182.4 million ( [https://aoa.vermont.gov/sites/aoa/files/revenue-economy/RevenueRpts/EPR\\_FINAL\\_ForecastUpdateReport\\_08.12.2020.pdf](https://aoa.vermont.gov/sites/aoa/files/revenue-economy/RevenueRpts/EPR_FINAL_ForecastUpdateReport_08.12.2020.pdf)).

While heartened to learn that some state funding for grants, income sensitivity for residents eligible for tax subsidies, and social services would not be cut for FY21, how the State Legislature will address a projected FY2022 budget deficit of \$103.8 million is unknown.

**Proposal:**

I would propose that the Selectboard provide guidance to the Town Manager(TM) to present a municipal budget reflecting no municipal tax increase. To offset the contractual increases in salary and benefits, I would ask the Town Manager to direct Department heads to review all discretionary spending with an even finer tooth comb. What line items can be reduced or eliminated while providing a similar level of service. What purchases can be deferred?

I would also propose that despite our recent fee schedule update, the Town Manager would look to increase revenues from non-tax sources by asking all department heads to re-assess the fee schedule (of course, excluding any statutory mandated fees) and keeping in mind that fee increases should not be directed at those least likely to be able to pay.

We know we will need to find funds for IT infrastructure improvements and to fund a Finance Director. Can we find creative ways for funding without adding to the tax rate?

The Selectboard needs to determine/decide what level of tax increase, if any, is acceptable. An increase of \$75,000 equates to an approximate 1 cent increase in the tax rate. While this may appear inconsequential to some, we have many residents in town on fixed incomes. For FY21, the municipal budget increased by 3.97% (\$169,380), excluding outside appropriations. I believe we need to be mindful of the residents in town who have struggled to find the funds to pay their taxes, put food on the table, and keep a roof over their heads. Given the State economic forecast for FY22, I believe it would be unwise for us to propose any increase in the municipal budget.

Respectfully,

Claudette

Additional information:

[https://www.vlct.org/sites/default/files/2020 weekly legislative report 28.pdf](https://www.vlct.org/sites/default/files/2020%20weekly%20legislative%20report%2028.pdf)

<https://mail.google.com/mail/u/0/?tab=wm#label/COVID-19/FMfcgxwJXxnTpPrsxdmtJtGgdxPJRhxL>